

LANDS OF APPLE, INC.  
 APN# 316-20-076

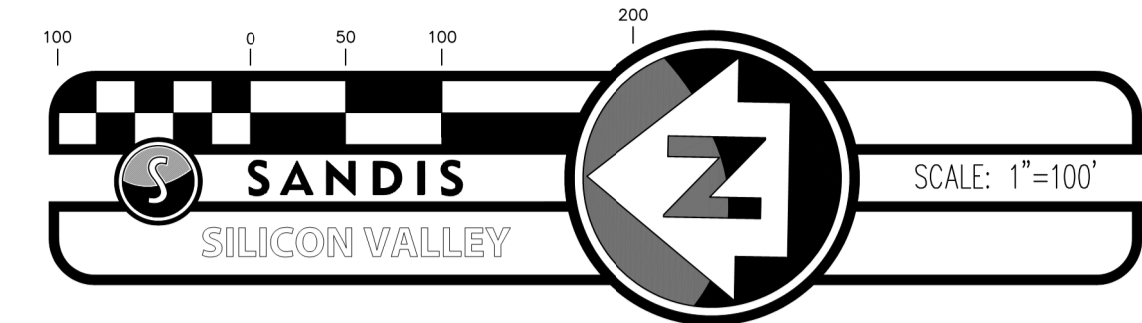

NO PART OF THIS DOCUMENT MAY BE REPRODUCED IN ANY FORM INCLUDING PHOTOCOPY, RECORDING OR ANY INFORMATION RETRIEVABLE AND STORAGE SYSTEM, WITHOUT PERMISSION IN WRITING FROM SANDIS.

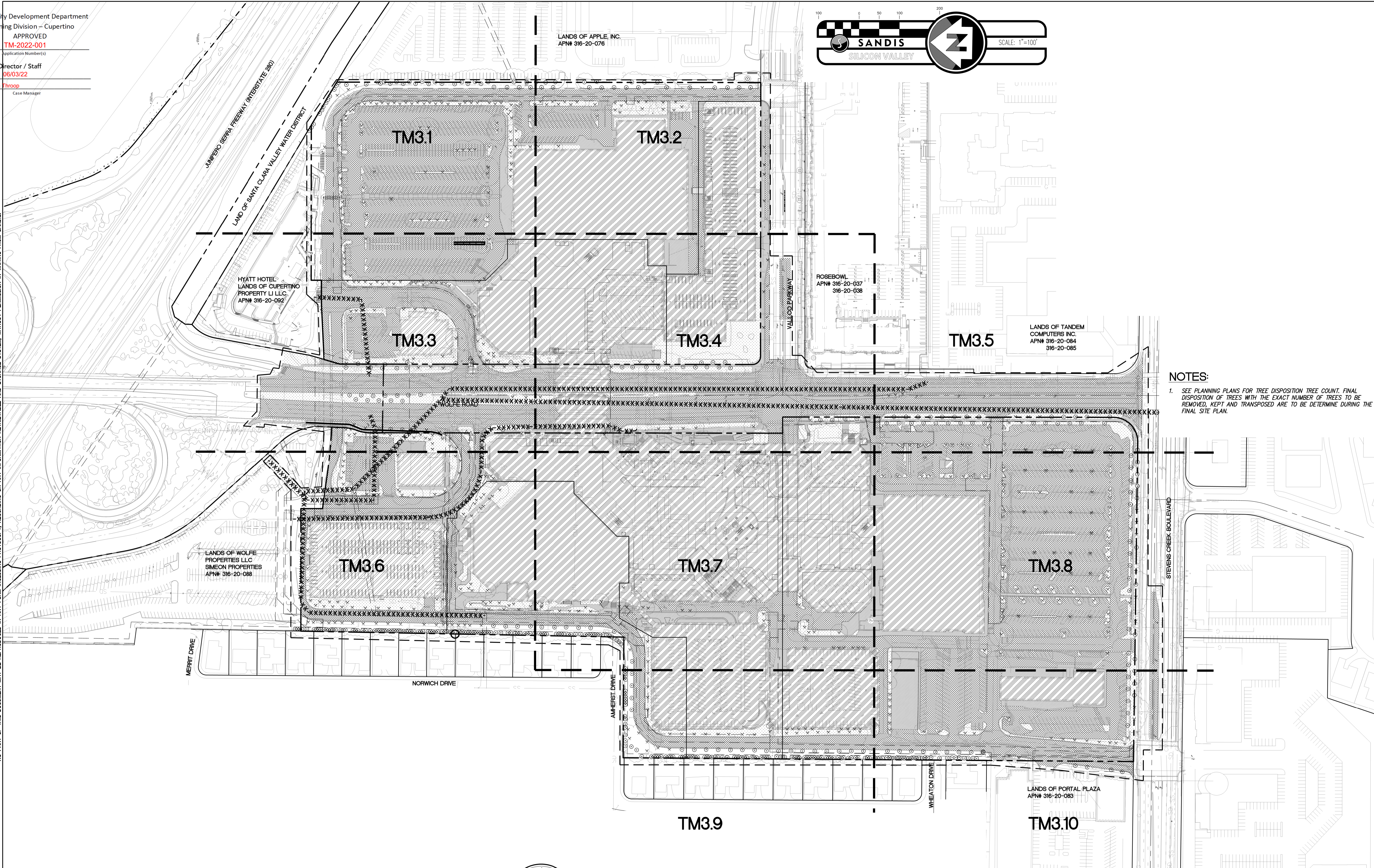

**NOTES:**  
 1. SEE PLANNING PLANS FOR TREE DISPOSITION TREE COUNT. FINAL DISPOSITION OF TREES WITH THE EXACT NUMBER OF TREES TO BE REMOVED, KEPT AND TRANSPOSED ARE TO BE DETERMINE DURING THE FINAL SITE PLAN.

**SANDIS** CIVIL ENGINEERS SURVEYORS PLANNERS  
 1700 S. Winchester Blvd, Suite 200, Campbell, CA 95008 | P. 408.636.0900 | F. 408.636.0999 | www.sandis.net  
 SILICON VALLEY TRI-VALLEY CENTRAL VALLEY SACRAMENTO EAST BAY/SF

DATE: 03/23/2022 DATE: MARCH 23, 2022  
 SCALE: 1"=100'  
 DRAWN BY: SP  
 APPROVED BY: ND  
 DRAWING NO.: 215028  
 KELLY S. JOHNSON  
 P.L.S. NO. 9126, EXPIRES 9-30-22

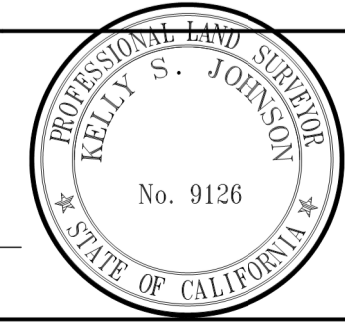

No.	REVISION/ISSUE	DATE	BY
REV-0	SB-35 DEVELOPMENT APPLICATION	03/27/2018	ND
REV-1	SB-35 APPLICATION REVISIONS	08/06/2018	ND
REV-2	SB-35 APPLICATION CONFORM SET	09/15/2018	ND
REV-3	SB-35 MODIFICATION DOCUMENTS	03/23/2022	ND

OVERALL  
 DEMOLITION AND  
 TREE DISPOSITION PLAN

TENTATIVE SUBDIVISION MAP  
 VALLCO TOWN CENTER  
 CUPERTINO CALIFORNIA

SHEET  
**TM3.0**  
 OF 73 SHEETS  
 Copyright © 2018 by Sandis