

SEQUENCE #3 - BASEMENT LEVEL

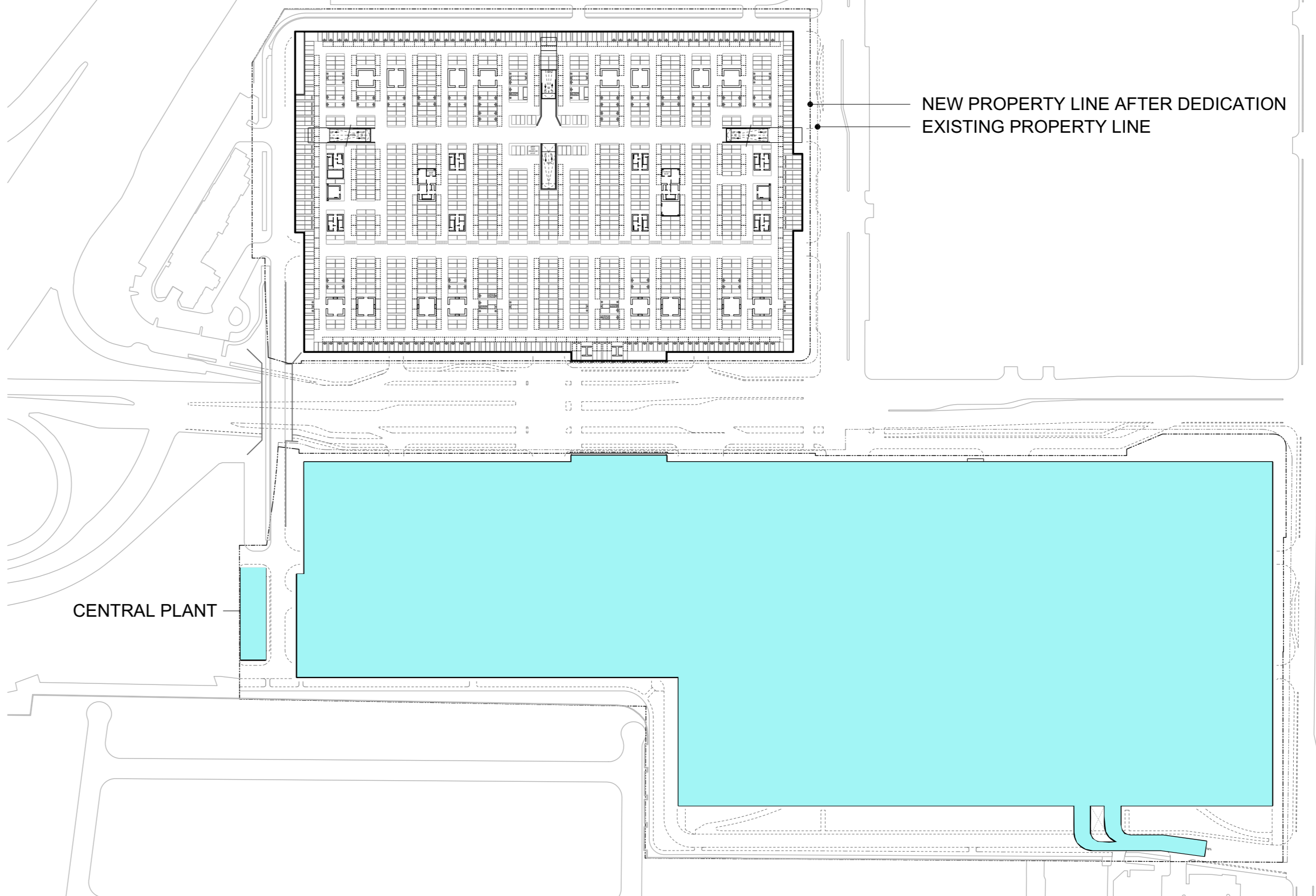

SEQUENCE #2 - BASEMENT LEVEL



SEQUENCE #1 - BASEMENT LEVEL

SEQUENCE #3 - BASEMENT LEVEL
NTS 3-B1

SEQUENCE #2 - BASEMENT LEVEL
NTS 2-B1

SEQUENCE #1 - BASEMENT LEVEL
NTS 1-B1

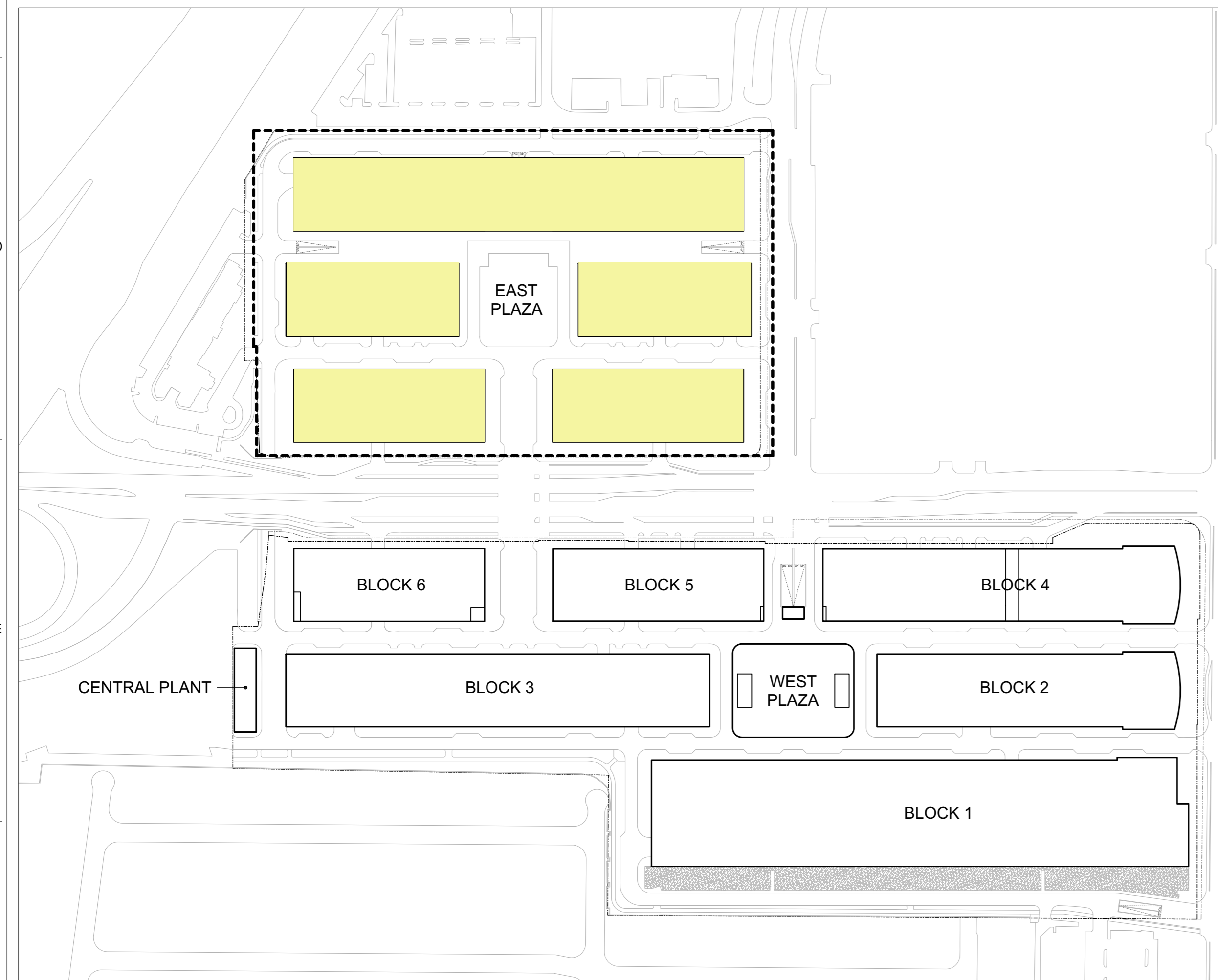

SEQUENCE #3 - GROUND FLOOR LEVEL

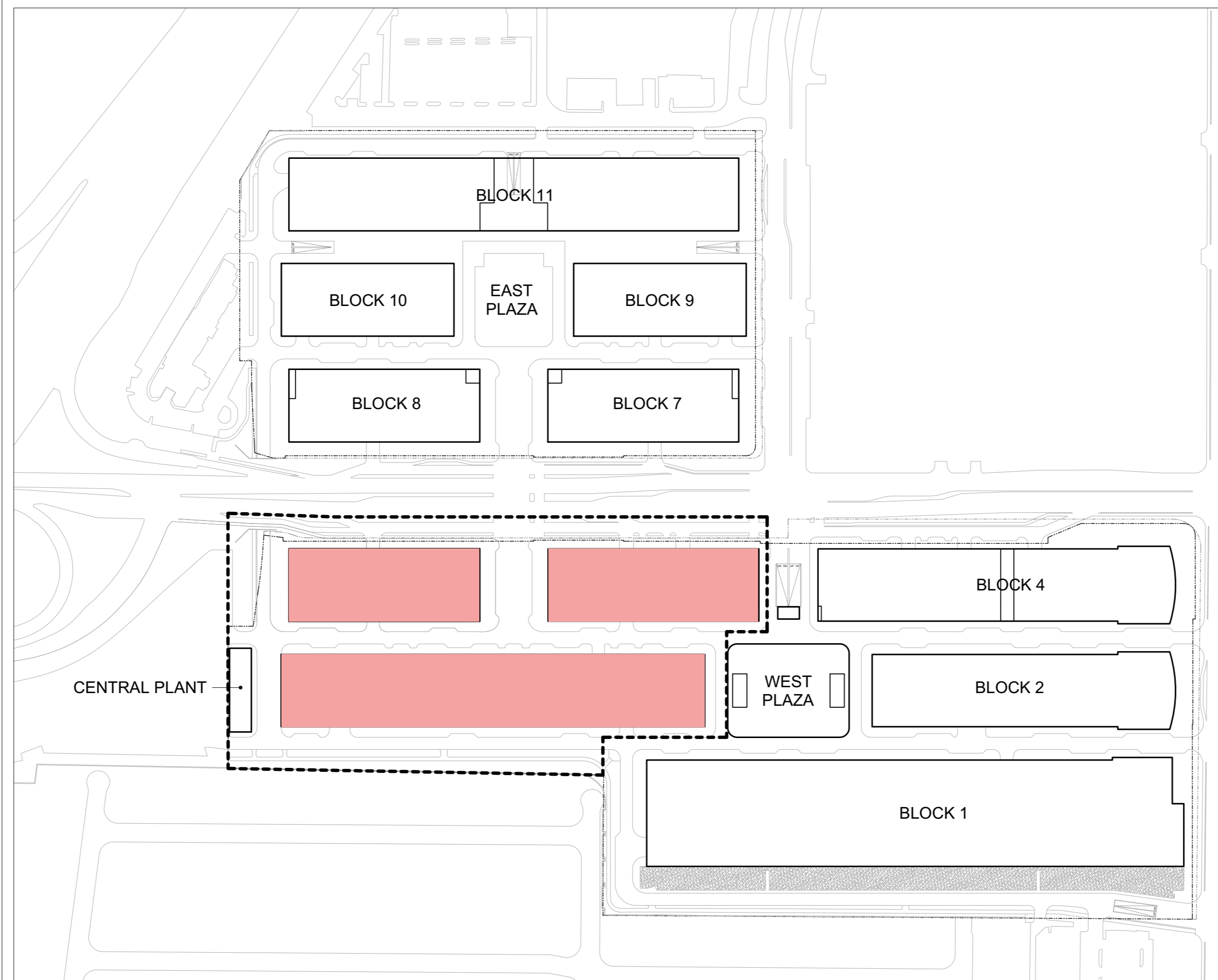

SEQUENCE #2 - GROUND FLOOR LEVEL

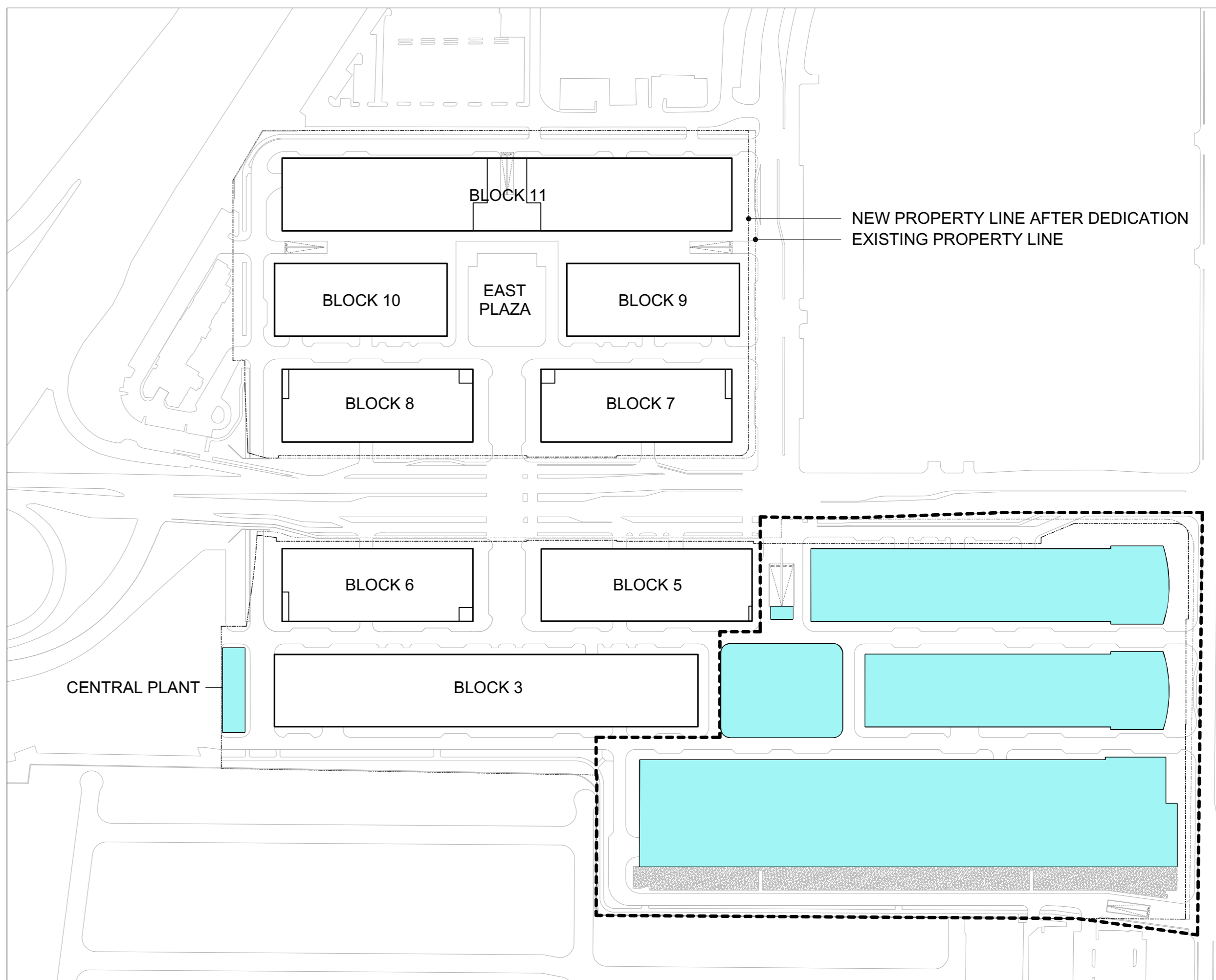

SEQUENCE #1 - GROUND FLOOR LEVEL

SEQUENCE #3 - GROUND FLOOR LEVEL
NTS 3-GF

SEQUENCE #2 - GROUND FLOOR LEVEL
NTS 2-GF

SEQUENCE #1 - GROUND FLOOR LEVEL
NTS 1-GF

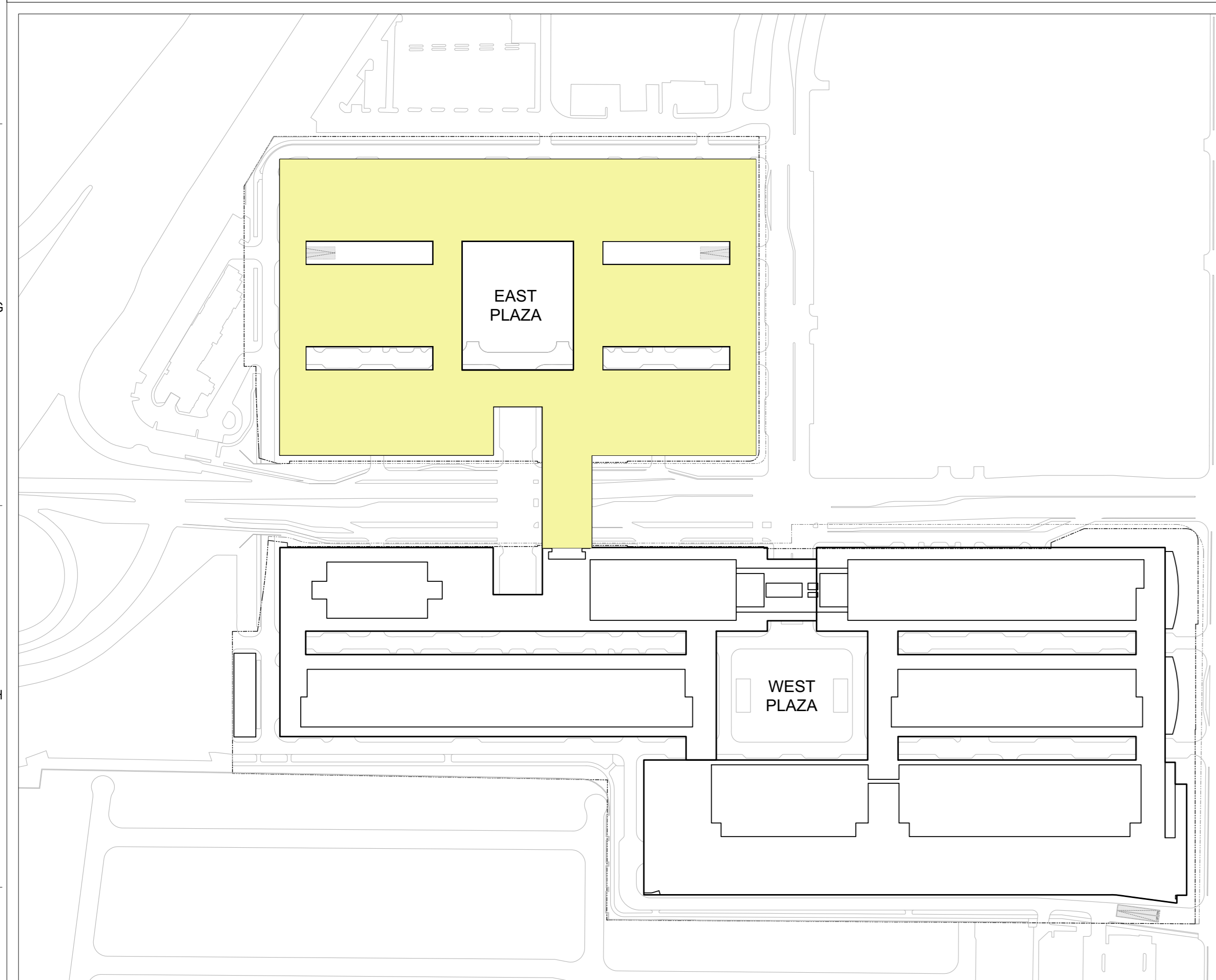

SEQUENCE #3 - GREEN ROOF LEVEL

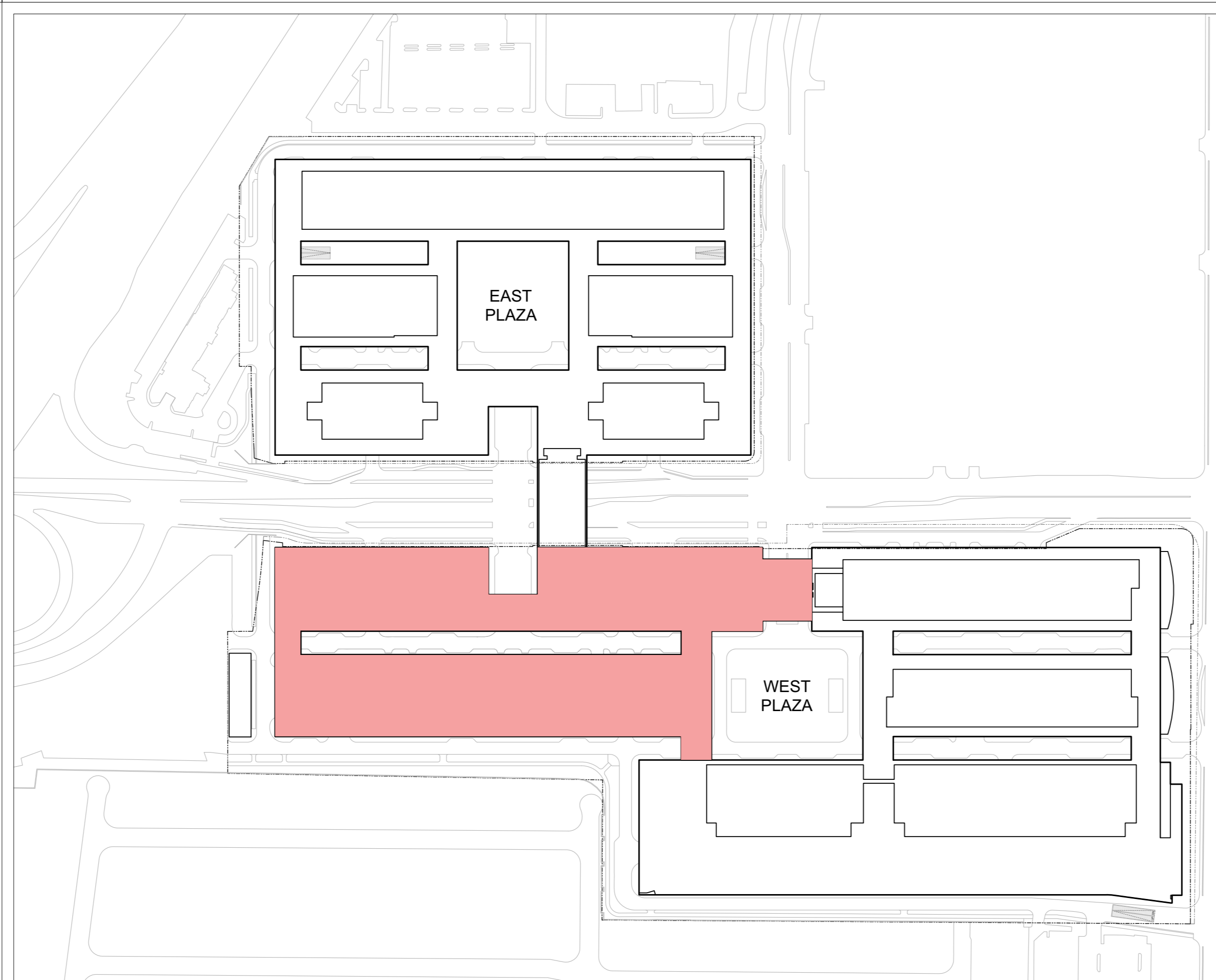

SEQUENCE #2 - GREEN ROOF LEVEL

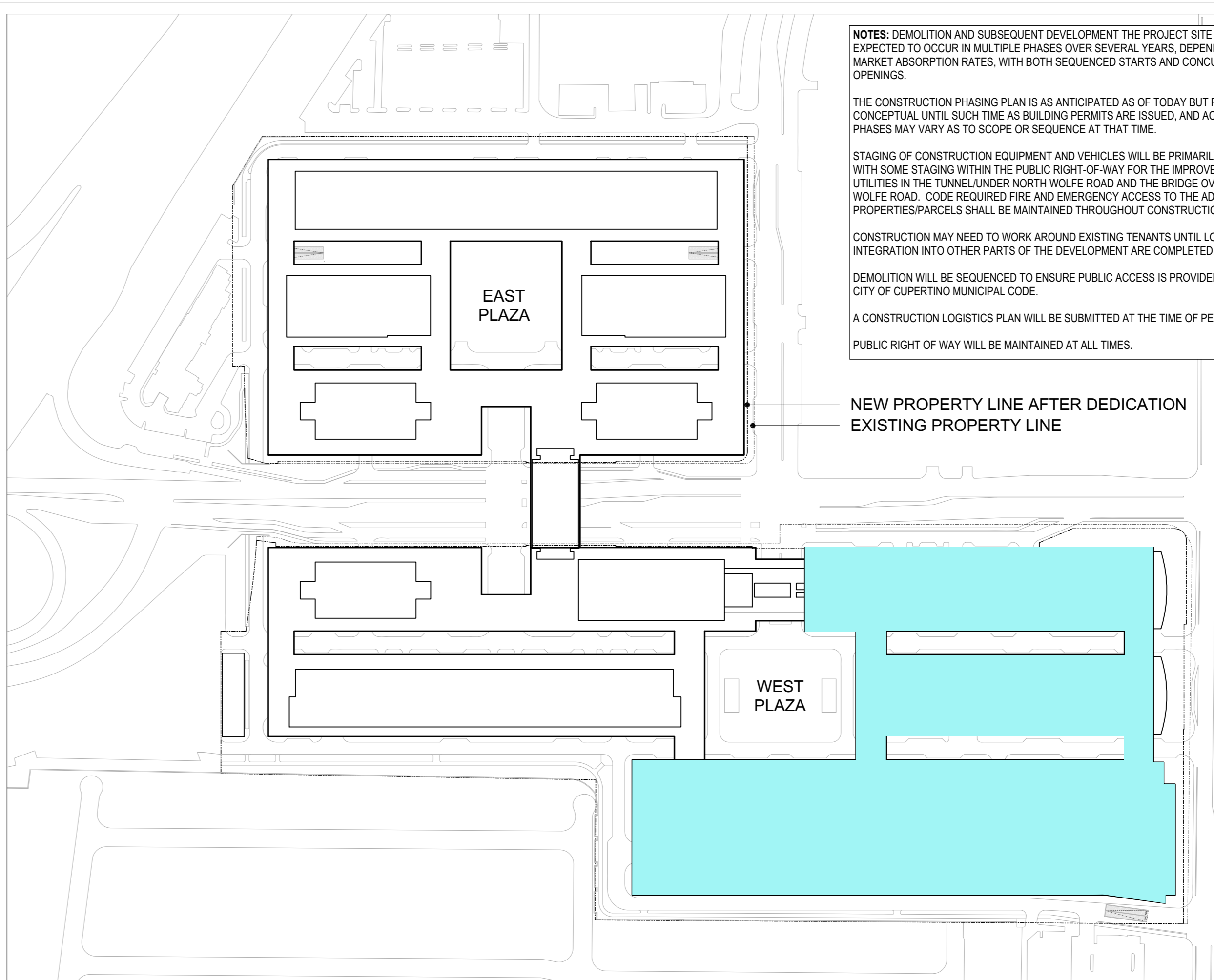

SEQUENCE #1 - GREEN ROOF LEVEL

SEQUENCE #3 - GREEN ROOF LEVEL
NTS 3-GR

SEQUENCE #2 - GREEN ROOF LEVEL
NTS 2-GR

SEQUENCE #1 - GREEN ROOF LEVEL
NTS 1-GR

NEW PROPERTY LINE AFTER DEDICATION
EXISTING PROPERTY LINE

NEW PROPERTY LINE AFTER DEDICATION
EXISTING PROPERTY LINE

NEW PROPERTY LINE AFTER DEDICATION
EXISTING PROPERTY LINE

NOTES: DEMOLITION AND SUBSEQUENT DEVELOPMENT OF THE PROJECT SITE IS EXPECTED TO OCCUR IN MULTIPLE PHASES OVER SEVERAL YEARS, DEPENDING ON MARKET ABSORPTION RATES, WITH BOTH SEQUENCED STARTS AND CONCURRENT OPENINGS.
 THE CONSTRUCTION PHASING PLAN IS AS ANTICIPATED AS OF TODAY BUT REMAINS CONCEPTUAL UNTIL SUCH TIME AS BUILDING PERMITS ARE ISSUED, AND ACTUAL PHASING MAY VARY AS TO SCOPE OR SEQUENCE AT THAT TIME.
 STAGING OF CONSTRUCTION EQUIPMENT AND VEHICLES WILL BE PRIMARILY ON-SITE WITH SOME STAGING WITHIN THE PUBLIC RIGHT-OF-WAY FOR THE IMPROVEMENT OF UTILITIES IN THE TUNNEL UNDER NORTH WOLFE ROAD AND THE BRIDGE OVER NORTH WOLFE ROAD. CODE REQUIRED FIRE AND EMERGENCY ACCESS TO THE ADJACENT PROPERTIES/PARCELS SHALL BE MAINTAINED THROUGHOUT CONSTRUCTION.
 CONSTRUCTION MAY NEED TO WORK AROUND EXISTING TENANTS UNTIL LONG-TERM INTEGRATION INTO OTHER PARTS OF THE DEVELOPMENT ARE COMPLETED.
 DEMOLITION WILL BE SEQUENCED TO ENSURE PUBLIC ACCESS IS PROVIDED PER THE CITY OF CUPERTINO MUNICIPAL CODE.
 A CONSTRUCTION LOGISTICS PLAN WILL BE SUBMITTED AT THE TIME OF PERMIT.
 PUBLIC RIGHT OF WAY WILL BE MAINTAINED AT ALL TIMES.

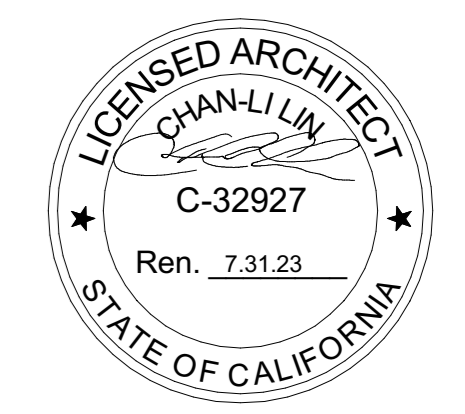

NOT FOR CONSTRUCTION
 STAMP / SIGNATURE

DISCLAIMER
 THE ARCHITECT / ENGINEER SHALL HAVE NO RESPONSIBILITY FOR ANY LIABILITY, LOSS, COST, DAMAGE OR EXPENSE ARISING FROM OR RELATING TO ANY USE OF THIS DOCUMENT FOR ANY PURPOSE OTHER THAN ITS INTENDED PURPOSE ON THIS PROJECT. THIS DOCUMENT IS TO BE CONSIDERED IN CONJUNCTION WITH ALL RELATED DOCUMENTATION. ANY DISCREPANCIES IDENTIFIED IN THIS DOCUMENT MUST BE REPORTED IMMEDIATELY TO THE ARCHITECT BEFORE PROCEEDING. CONTRACTORS MUST VERIFY ALL DIMENSIONS PRIOR TO PROCEEDING WITH ANY WORK. ONLY FIGURED DIMENSIONS ARE TO BE USED FOR VERIFICATION.

SB-35 MODIFICATION APPLICATION

REV	DESCRIPTION	DATE
REV-0	SB-35 DEVELOPMENT APPLICATION	03/27/2018
REV-1	SB-35 APPLICATION - REVISION	07/31/2018
REV-2	SB-35 APPLICATION - CONFIRM SET	08/15/2018
REV-3	SB-35 MODIFICATION APPLICATION	03/23/2022

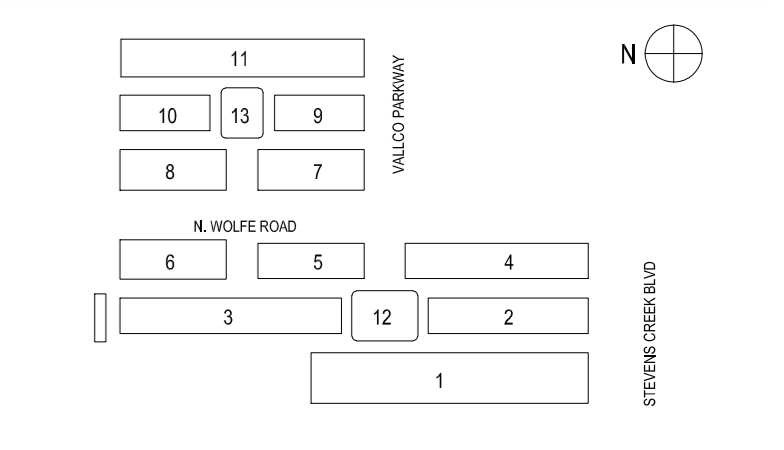

KEY PLAN AND NORTH ARROW
 ARCHITECTS PROJECT NUMBER 708.012

IF THIS DRAWING IS NOT 36"X48" IT IS A REDUCED PRINT.
 REFER TO GRAPHIC SCALE



SCALE NOT TO SCALE
 SITE DIAGRAMS -
 CONSTRUCTION SEQUENCES

SHEET TITLE
P-0510