

# VALLCO TOWN CENTER

OWNER - VALLCO PROPERTY OWNER LLC  
 965 PAGE MILL ROAD, PALO ALTO, CA 94304  
 T. 650-344-1500  
 ARCHITECTURE - RAFAEL VINYOL ARCHITECTS  
 50 VANDAM STREET, NEW YORK, NY 10013  
 T. 212-924-5000  
 ARCHITECTURE - RAFAEL VINYOL ARCHITECTS  
 1031 N. WOLFE ROAD, CUPERTINO CA 95014  
 T. 408-627-7000  
 LANDSCAPE ARCHITECTURE - OLIN PARTNERSHIP LTD.  
 192 S. INDEPENDENCE HALL, W. SHITE 1123, PHILADELPHIA, PA 19106  
 T. 215-440-0000  
 CIVIL - SANDS CIVIL ENGINEERS SURVEYORS PLANNERS, INC.  
 1700 S. WINCHESTER BLVD, SUITE 200, CAMPBELL, CA 95008  
 T. 408-836-0000  
 TRANSPORTATION ENGINEERING - ARUP NORTH AMERICA, LTD.  
 860 MISSION STREET SUITE 700 SAN FRANCISCO CA 94105  
 T. 415-997-9445  
 LIGHTING - ONE LUX STUDIO  
 158 WEST 29TH STREET, 10TH FLOOR, NEW YORK, NY 10001  
 T. 212-321-9790  
 SIGNAGE - EXIT  
 1817 JFK BLVD, SUITE 1665, PHILADELPHIA, PA 19103  
 T. 215-961-1050  
 PARKING ENGINEERING - WATRY DESIGN, INC.  
 2096 GATEWAY PLACE, SUITE 550, SAN JOSE, CA 95110  
 T. 408-992-7500  
 WASTE MANAGEMENT - CIN LITTLE INTERNATIONAL  
 535 NORTH BRAN BLVD, STE 710 GLENDALE, CA 92103  
 T. 828-441-7700

## LEGEND

- PROPERTY LINE
- CENTERLINE FOR ROADWAY PURPOSES
- EASEMENT LINE
- ELECTRICAL EASEMENTS
- PUBLIC UTILITY EASEMENTS
- ROADWAY EASEMENT
- SANITARY SEWER EASEMENT
- FOOTING EASEMENT
- VEHICULAR AND PEDESTRIAN INGRESS/EGRESS EASEMENT
- SIDEWALK EASEMENT
- STORM EASEMENT
- TELEPHONE EASEMENTS
- WATERLINE EASEMENTS
- AIR RIGHTS EASEMENTS

## EASEMENT TABLE

| Easement Type                             | Recorded   | Book / Page (Document No)                         | For Benefit of (Granted to)                 |
|---|------------|---|---|
| Public Utilities                          | 12/10/1964 | Book 6774 O.R. 471 / Document Number 2758221      | City of Cupertino                           |
| Public Utilities                          | 12/7/1966  | Book 7582 O.R. 612 / Document Number 3155358      | City of Cupertino                           |
| Public Utilities                          | 12/7/1966  | Book 7583 O.R. 613 / Document Number 3155359      | City of Cupertino                           |
| Pacific Gas & Electric                    | 3/1/1973   | Book 0259 O.R. 406 / Document Number 4462287      | Pacific Gas and Electric Company            |
| Waterline Easement                        | 3/13/1975  | Book B316 O.R. 711 / Document Number 4963967      | California Water Service Company            |
| Waterline Easement                        | 3/21/1975  | Book B328 O.R. 575 / Document Number 4969571      | California Water Service Company            |
| Waterline Easement                        | 4/30/1975  | Book B385 O.R. 582 / Document Number 4996123      | California Water Service Company            |
| Waterline Easement                        | 6/2/1975   | Book B440 O.R. 668 / Document Number 5020710      | California Water Service Company            |
| Pacific Gas & Electric                    | 6/1/1975   | Book B456 O.R. 557 / Document Number 5028101      | Pacific Gas and Electric Company            |
| Sanitary Sewer Easement                   | 7/17/1975  | Book B509 O.R. 199 / Document Number 5051027      | Cupertino Sanitary District                 |
| Telephone Easement                        | 7/25/1975  | Book B521 O.R. 653 / Document Number 5056855      | The Pacific Telephone and Telegraph Company |
| Roadway Purpose/Public Utilities          | 7/29/1975  | Book B526 O.R. 74 / Document Number 5058714       | City of Cupertino                           |
| Sanitary Sewer Easement                   | 3/24/1976  | Book B933 O.R. 001 / Document Number 5248044      | Cupertino Sanitary District                 |
| Waterline Easement                        | 8/16/1977  | Book D077 O.R. 508 / Document Number 5756685      | California Water Service Company            |
| Waterline Easement                        | 11/15/1984 | Book J038 O.R. 739 / Document Number 8249110      | California Water Service Company            |
| Waterline Easement                        | 11/15/1984 | Book J038 O.R. 743 / Document Number 8249111      | California Water Service Company            |
| Waterline Easement                        | 7/27/1987  | Book K238 O.R. 1237 / Document Number 9371313     | California Water Service Company            |
| Waterline Easement                        | 12/7/1987  | Book K381 O.R. 1282 / Document Number 9529360     | California Water Service Company            |
| Waterline Easement                        | 5/18/2007  | Document Number 19436776                          | California Water Service Company            |
| Waterline Easement                        | 10/14/2008 | Document Number 20013411                          | California Water Service Company            |
| Sanitary Sewer Easement                   | 11/19/1958 | Book 4234 O.R. 285 / Document Number 1544813      | Cupertino Sanitary District                 |
| Roadway Purposes/Public Utility Easement  | 12/10/1964 | Book 6774 O.R. Page 458 / Document Number 2758219 | City of Cupertino                           |
| Public Utility Easement                   | 12/10/1964 | Book 6774 O.R. 476 / Document Number 2758222      | City of Cupertino                           |
| Public Utility Easement/10' PG&E Easement | 8/22/1969  | Book B647 O.R. 495 / Document Number 3673193      | George Yamashita, et al                     |
| Roadway Purposes                          | 4/1/1975   | Book B366 O.R. 393 / Document Number 4987239      | City of Cupertino                           |
| Sidewalk Easement                         | 3/13/2013  | Document Number 22132168                          | City of Cupertino                           |
| Stormwater Management Facilities          | 3/13/2013  | Document Number 22132169                          | City of Cupertino                           |
| Perpetual and exclusive Easements         | 10/17/1974 | Book B135 O.R. 370                                | City of Cupertino and Vallco Park Ltd.      |
| Public Utility Easement/10' PG&E Easement | 6/19/1973  | Book 325 of Maps, Page 12                         | City of Cupertino/PG&E                      |
| Future Freeway Widening                   | 6/19/1973  | Book 325 of Maps, Page 12                         | City of Cupertino                           |
| Perpetual and Exclusive Easements         | 10/17/1974 | Book B135 O.R. 370 / Document Number 4877118      | City of Cupertino and Vallco Park Ltd.      |

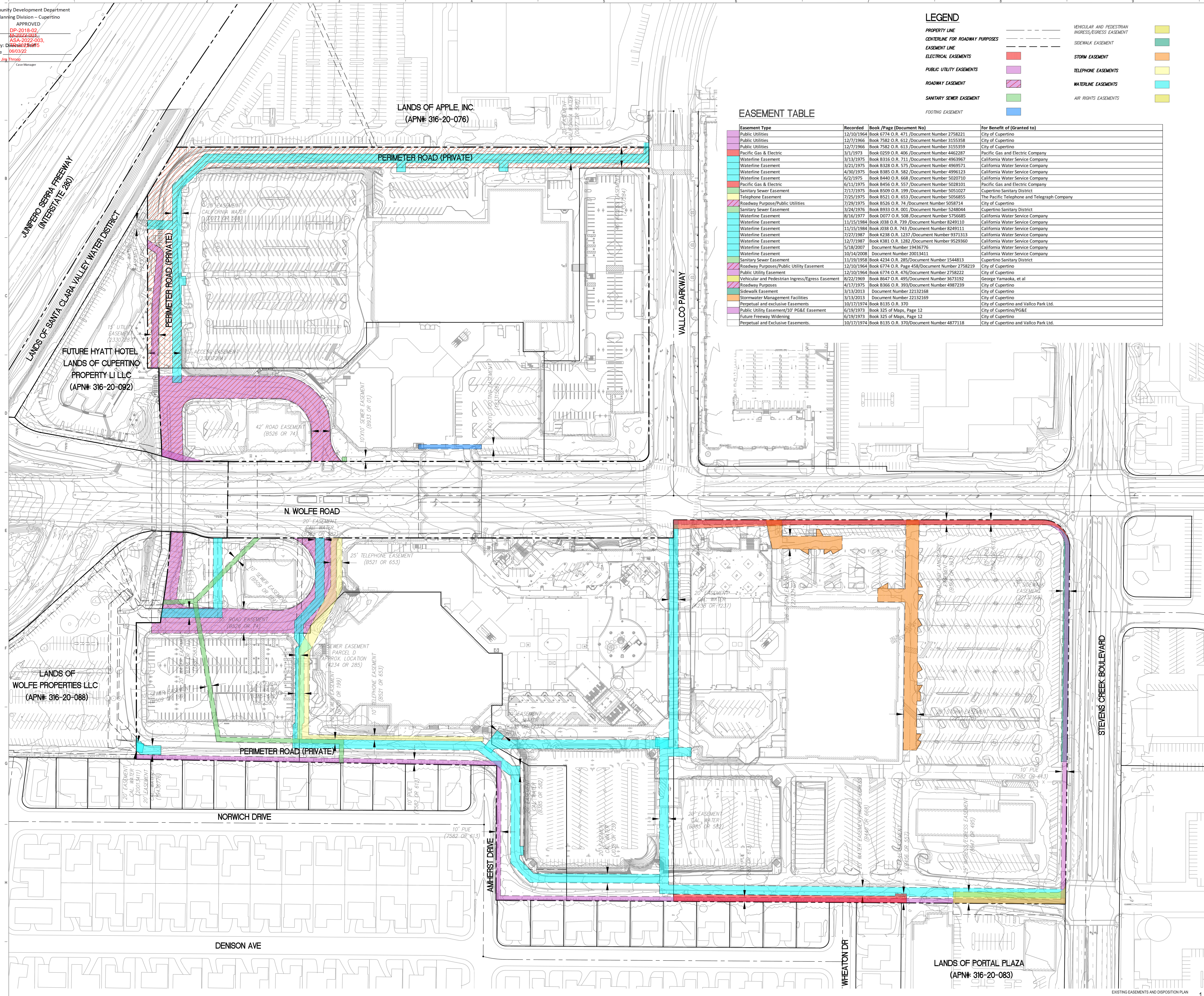

**NOT FOR CONSTRUCTION**

DISCLAIMER  
 THE ARCHITECT/ENGINEER SHALL HAVE NO RESPONSIBILITY FOR ANY LIABILITY, LOSS, COST, DAMAGE OR EXPENSE ARISING FROM OR RELATING TO ANY USE OF THIS DOCUMENT FOR ANY PURPOSE OTHER THAN ITS INTENDED PURPOSE ON THIS PROJECT. THIS DOCUMENT IS TO BE CONSIDERED IN CONJUNCTION WITH ALL RELATED DOCUMENTATION. ANY DISCREPANCIES IDENTIFIED IN THIS DOCUMENT MUST BE REPORTED IMMEDIATELY TO THE ARCHITECT BEFORE PROCEEDING. CONTRACTORS MUST VERIFY ALL DIMENSIONS PRIOR TO PROCEEDING WITH ANY WORK. ONLY FIGURED DIMENSIONS ARE TO BE USED FOR VERIFICATION.

## SB-35 DEVELOPMENT APPLICATION

| REV   | DESCRIPTION                   | DATE       |
|-------|-------------------------------|------------|
| REV 0 | SB-35 DEVELOPMENT APPLICATION | 03/27/2018 |
| REV 1 | SB-35 APPLICATION REVISIONS   | 06/06/2018 |
| REV 2 | SB-35 APPLICATION CONFORM SET | 09/15/2018 |

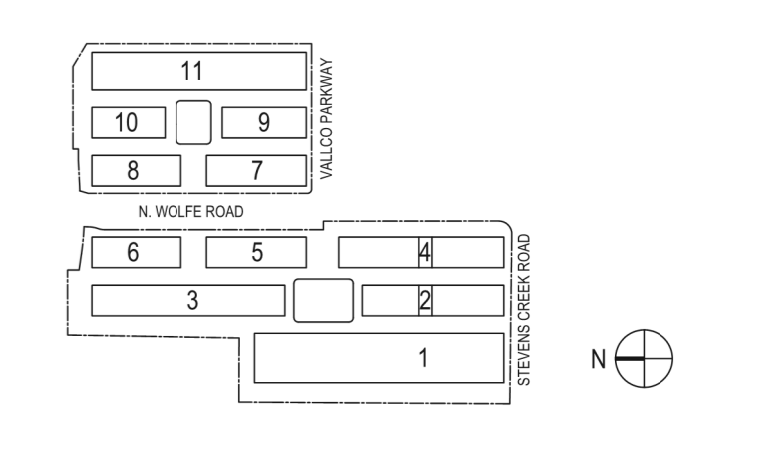

KEY PLAN AND NORTH ARROW

ARCHITECTS PROJECT NUMBER: 708011

PROJECT PHASE: SB-35 DEVELOPMENT APPLICATION

IF THIS DRAWING IS NOT 36"x48" IT IS A REDUCED PRINT. REFER TO GRAPHIC SCALE.

SCALE: 0 32 64 128 192 164"x1'-0"

## EXISTING EASEMENTS PLAN

SHEET TITLE: P-0306

SHEET NUMBER: 1

© 2018 RAFAEL VINYOL ARCHITECTS PCL