

VALLCO TOWN CENTER

OWNER - VALLCO PROPERTY OWNER LLC
 965 PAGE MILL ROAD, PALO ALTO, CA 94304
 T. 650-344-1500
 ARCHITECTURE - RAFAEL VINOLY ARCHITECTS
 50 WANDAM STREET, NEW YORK, NY 10013
 T. 212-922-5000
 ARCHITECTURE - RAFAEL VINOLY ARCHITECTS
 1033 N. WOLFE ROAD, CUPERTINO, CA 95014
 T. 408-627-7000
 LANDSCAPE ARCHITECTURE - OLIN PARTNERSHIP LTD.
 150 S. INDEPENDENCE HALL, W. SHIRTS 1120, PHILADELPHIA, PA 19106
 T. 215-440-0000
 CIVIL - SANDS CIVIL ENGINEERS SURVEYORS PLANNERS, INC.
 1700 S. WINCHESTER BLVD, SUITE 200, CAMPBELL, CA 95008
 T. 408-836-0500
 TRANSPORTATION ENGINEERING - ARUP NORTH AMERICA, LTD.
 560 MISSION STREET, SUITE 700 SAN FRANCISCO CA 94105
 T. 415-957-9445
 LIGHTING - ONE LUX STUDIO
 158 WEST 29TH STREET, 10TH FLOOR, NEW YORK, NY 10001
 T. 212-301-9790
 SIGNAGE - EX-IT
 1817 JFK BLVD, SUITE 1665, PHILADELPHIA, PA 19103
 T. 215-561-1550
 PARKING ENGINEERING - WATRY DESIGN, INC.
 2090 GATEWAY PLACE, SUITE 550, SAN JOSE, CA 95110
 T. 408-292-7500
 WASTE MANAGEMENT - CIN LITTLE INTERNATIONAL
 535 NORTH BRAN BLVD, STE 710 GLENDALE, CA 92103
 T. 825-441-7700

GENERAL NOTES
 PROPERTY LINE CENTERLINE
 FEE PARCELS PER TITLE REPORT ORDER NO. 98201069-982-SK-KC
 FEE PARCELS PER TITLE REPORT ORDER NO. 98201069-982-SK-KC
 FEE PARCELS PER TITLE REPORT ORDER NO. 98201069-982-SK-KC

TITLE REPORT NOTE
 THE PROPERTY DESCRIBED AND SHOWN HEREON IS THE SAME PROPERTY AS DESCRIBED IN THE CHICAGO TITLE ASSURANCE COMPANY PRELIMINARY TITLE REPORTS, ORDER NUMBERS 98201069-982-SK-KC AND 98201070-982-SK-KC; BOTH DATED NOVEMBER 20, 2017

PARCEL A

Line #	Length	Direction
AL1	26.75'	N01° 20' 50"E
AL2	1019.74'	N01° 05' 14"W
AL3	40.00'	S88° 54' 46"W
AL4	819.01'	N01° 05' 14"W
AL5	792.04'	N89° 36' 00"E
AL6	1263.89'	S00° 43' 00"E
AL7	299.09'	S89° 12' 40"W
AL8	799.89'	S00° 05' 00"E
AL9	303.11'	S88° 50' 57"W
AL10	53.51'	N01° 09' 03"W
AL11	76.01'	N82° 53' 14"W
AL12	286.11'	S88° 54' 46"W
AL13	24.08'	S01° 05' 14"E
AL14	16.22'	S88° 54' 46"W
AL15	106.07'	S46° 05' 14"E
AL16	215.11'	S01° 05' 14"E
AL17	29.29'	S88° 54' 46"W
AL18	150.58'	S43° 54' 46"W
AL19	29.43'	S01° 05' 14"E
AL20	115.55'	S88° 54' 46"W
AL21	23.23'	S01° 05' 14"E
AL22	86.48'	S88° 54' 46"W
AL23	95.50'	S28° 54' 46"W
AL24	83.48'	S01° 05' 14"E
AL25	299.56'	S88° 54' 46"W
AL26	807.08'	S88° 54' 46"W

PARCEL B

Line #	Length	Direction
BL1	123.59'	N80° 16' 27"W
BL2	1049.61'	N01° 05' 14"W
BL3	676.04'	N88° 54' 46"E
BL4	1021.53'	N01° 05' 14"W
BL5	41.27'	N15° 08' 31"E
BL6	119.28'	S88° 05' 45"W
BL7	55.94'	S88° 54' 46"W
BL8	25.28'	S01° 05' 14"E
BL9	394.58'	S88° 54' 46"W
BL10	407.40'	S01° 05' 14"E
BL11	75.68'	S46° 05' 14"E
BL12	48.02'	N88° 54' 46"E
BL13	347.85'	S01° 05' 14"E
BL14	65.00'	S88° 54' 46"W
BL15	46.19'	S01° 05' 14"E
BL16	20.62'	S88° 54' 46"W
BL17	223.23'	S88° 54' 46"W
BL18	78.50'	N01° 05' 14"W
BL19	428.06'	S88° 54' 46"W
BL20	154.38'	N01° 05' 14"W

Curve Table

Curve #	Length	Radius	Delta
BC1	31.42'	20.00'	90°00'00"
BC2	20.74'	528.00'	215°02'

Curve Table

Curve #	Length	Radius	Delta
AC1	127.88'	1368.73'	52°12'
AC2	32.06'	100.00'	182°21'
AC3	36.31'	100.00'	20°48'15"
AC4	94.97'	60.00'	90°41'14"

EXISTING PARCEL AREA [ACRES]

PARCEL ONE [DOC. #19069106]	4.93
PARCEL TWO	2.71
PARCEL THREE	9.98
PARCEL 1-A (2)	4.58
PARCEL 1-C1 (2)	11.58
PARCEL ONE [DOC. #22746588 O.R.]	17.04
TOTAL	50.82

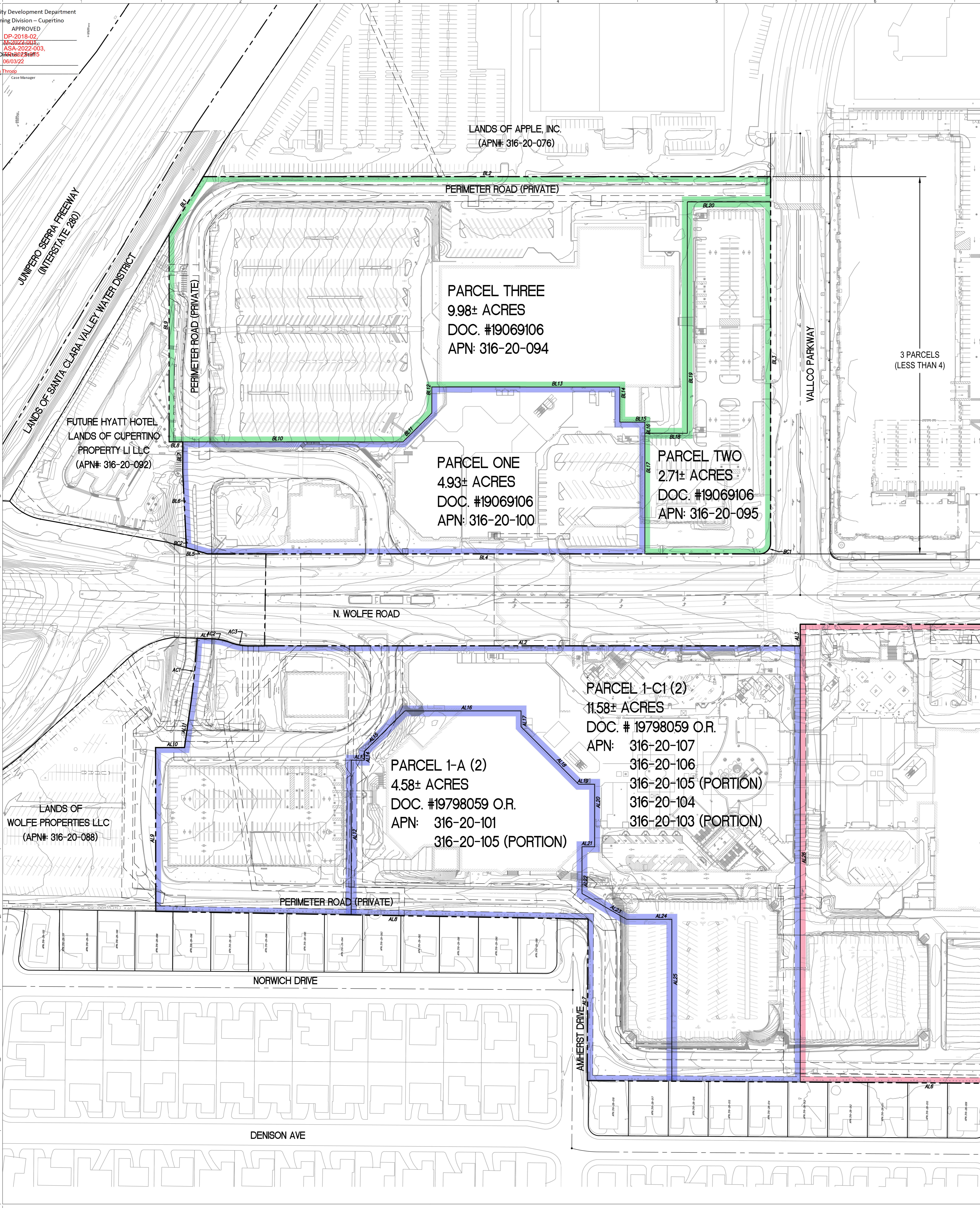

3 PARCELS (LESS THAN 4)

3 PARCELS (LESS THAN 4)

NOT FOR CONSTRUCTION

DISCLAIMER
 THE ARCHITECT/ENGINEER SHALL HAVE NO RESPONSIBILITY FOR ANY LIABILITY, LOSS, COST, DAMAGE OR EXPENSE ARISING FROM OR RELATING TO ANY USE OF THIS DOCUMENT FOR ANY PURPOSE OTHER THAN ITS INTENDED PURPOSE ON THIS PROJECT. THIS DOCUMENT IS TO BE CONSIDERED IN CONJUNCTION WITH ALL RELATED DOCUMENTATION. ANY DISCREPANCIES IDENTIFIED IN THIS DOCUMENT MUST BE REPORTED IMMEDIATELY TO THE ARCHITECT BEFORE PROCEEDING. CONTRACTORS MUST VERIFY ALL DIMENSIONS PRIOR TO PROCEEDING WITH ANY WORK. ONLY FIGURED DIMENSIONS ARE TO BE USED FOR VERIFICATION.

SB-35 DEVELOPMENT APPLICATION

REV	DESCRIPTION	DATE
REV0	SB-35 DEVELOPMENT APPLICATION	03/27/2018
REV1	SB-35 APPLICATION REVISIONS	06/06/2018
REV2	SB-35 APPLICATION CONFORM SET	09/15/2018

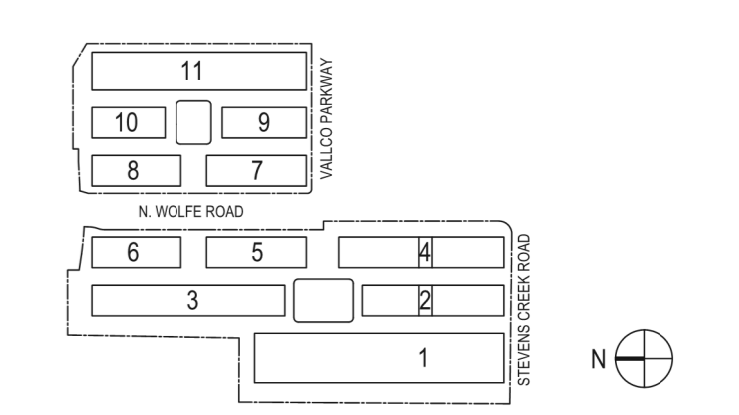

KEY PLAN AND NORTH ARROW
 ARCHITECTS PROJECT NUMBER: 708011
 PROJECT PHASE: SB-35 DEVELOPMENT APPLICATION
 IF THIS DRAWING IS NOT 36"X48" IT IS A REDUCED PRINT. REFER TO GRAPHIC SCALE.
 SCALE: 0 32 64 128 192 164"=1'-0"

EXISTING PARCELS

SHEET TITLE: P-0303
 SHEET NUMBER: 1
 © 2018 RAFAEL VINOLY ARCHITECTS PCL