

VALLCO TOWN CENTER

LEGEND

- STORM DRAIN — SD
- SANITARY SEWER — SS
- WATER LINES — W
- GAS LINES — G
- COMMUNICATION LINES — CMN
- FIRE WATER LINES — FW
- ELECTRIC LINES — E

EXISTING UTILITY NOTES

THE EXISTING UTILITIES SHOWN ARE NOT A FULL INVENTORY OF WHAT IS EXISTING IN FIELD. IF ANY UTILITIES ARE FOUND IN FIELD THAT ARE NOT SHOWN, CONTRACTOR IS TO NOTIFY ENGINEER IMMEDIATELY.

OWNER - VALLCO PROPERTY OWNER LLC
965 PAGE MILL ROAD, PALO ALTO, CA 94304
T. 650-344-1500

ARCHITECTURE - RAFAEL VINOLY ARCHITECTS
50 WANDAM STREET, NEW YORK, NY 10013
T. 212-924-5000

ARCHITECTURE - RAFAEL VINOLY ARCHITECTS
1033 N. WOLFERS ROAD, CUPERTINO CA 95014
T. 408-627-7000

LANDSCAPE ARCHITECTURE - OLIN PARTNERSHIP LTD.
192 S. INDEPENDENCE HALL, W. SUITE 1120, PHILADELPHIA, PA 19106
T. 215-440-0000

CIVIL - SANDS CIVIL ENGINEERS SURVEYORS PLANNERS, INC.
1700 S. WINCHESTER BLVD, SUITE 200, CAMPBELL, CA 95008
T. 408-836-0500

TRANSPORTATION ENGINEERING - ARUP NORTH AMERICA, LTD.
860 MISSION STREET SUITE 700 SAN FRANCISCO CA 94105
T. 415-957-9445

LIGHTING - ONE LUX STUDIO
158 WEST 29TH STREET, 10TH FLOOR, NEW YORK, NY 10001
T. 212-320-9790

SIGNAGE - EXIT
1817 JFK BLVD, SUITE 1665, PHILADELPHIA, PA 19103
T. 215-961-1590

PARKING ENGINEERING - WATRY DESIGN, INC.
2090 GATEWAY PLACE, SUITE 550, SAN JOSE, CA 95110
T. 408-292-7500

WASTE MANAGEMENT - CN-LITTLE INTERNATIONAL
535 NORTH BRAN BLVD, STE 710 GLENDALE, CA 92103
T. 626-441-7700

NOT FOR CONSTRUCTION

DISCLAIMER
THE ARCHITECT/ENGINEER SHALL HAVE NO RESPONSIBILITY FOR ANY LIABILITY, LOSS, COST, DAMAGE OR EXPENSE ARISING FROM OR RELATING TO ANY USE OF THIS DOCUMENT FOR ANY PURPOSE OTHER THAN ITS INTENDED PURPOSE ON THIS PROJECT. THIS DOCUMENT IS TO BE CONSIDERED IN CONJUNCTION WITH ALL RELATED DOCUMENTATION. ANY DISCREPANCIES IDENTIFIED IN THIS DOCUMENT MUST BE REPORTED IMMEDIATELY TO THE ARCHITECT BEFORE PROCEEDING. CONTRACTORS MUST VERIFY ALL DIMENSIONS PRIOR TO PROCEEDING WITH ANY WORK. ONLY FIGURED DIMENSIONS ARE TO BE USED FOR VERIFICATION.

SB-35 DEVELOPMENT APPLICATION

REV	DESCRIPTION	DATE
REV 0	SB-35 DEVELOPMENT APPLICATION	03/27/2018
REV 1	SB-35 APPLICATION REVISIONS	06/06/2018
REV 2	SB-35 APPLICATION CONFORMS SET	09/15/2018

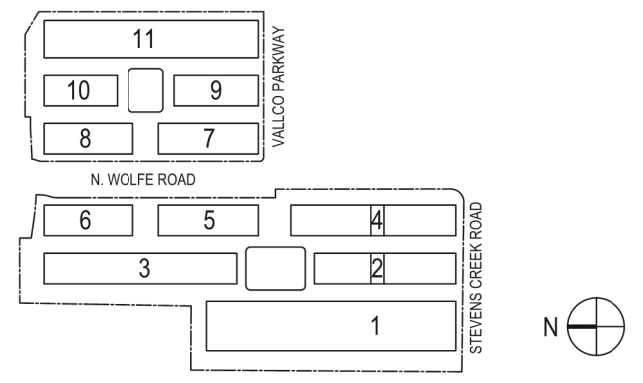

ARCHITECTS PROJECT NUMBER 708011
PROJECT PHASE SB-35 DEVELOPMENT APPLICATION

IF THIS DRAWING IS NOT 36"x48" IT IS A REDUCED PRINT. REFER TO GRAPHIC SCALE.



EXISTING UTILITIES

SHEET TITLE
P-0405

SHEET NUMBER
1

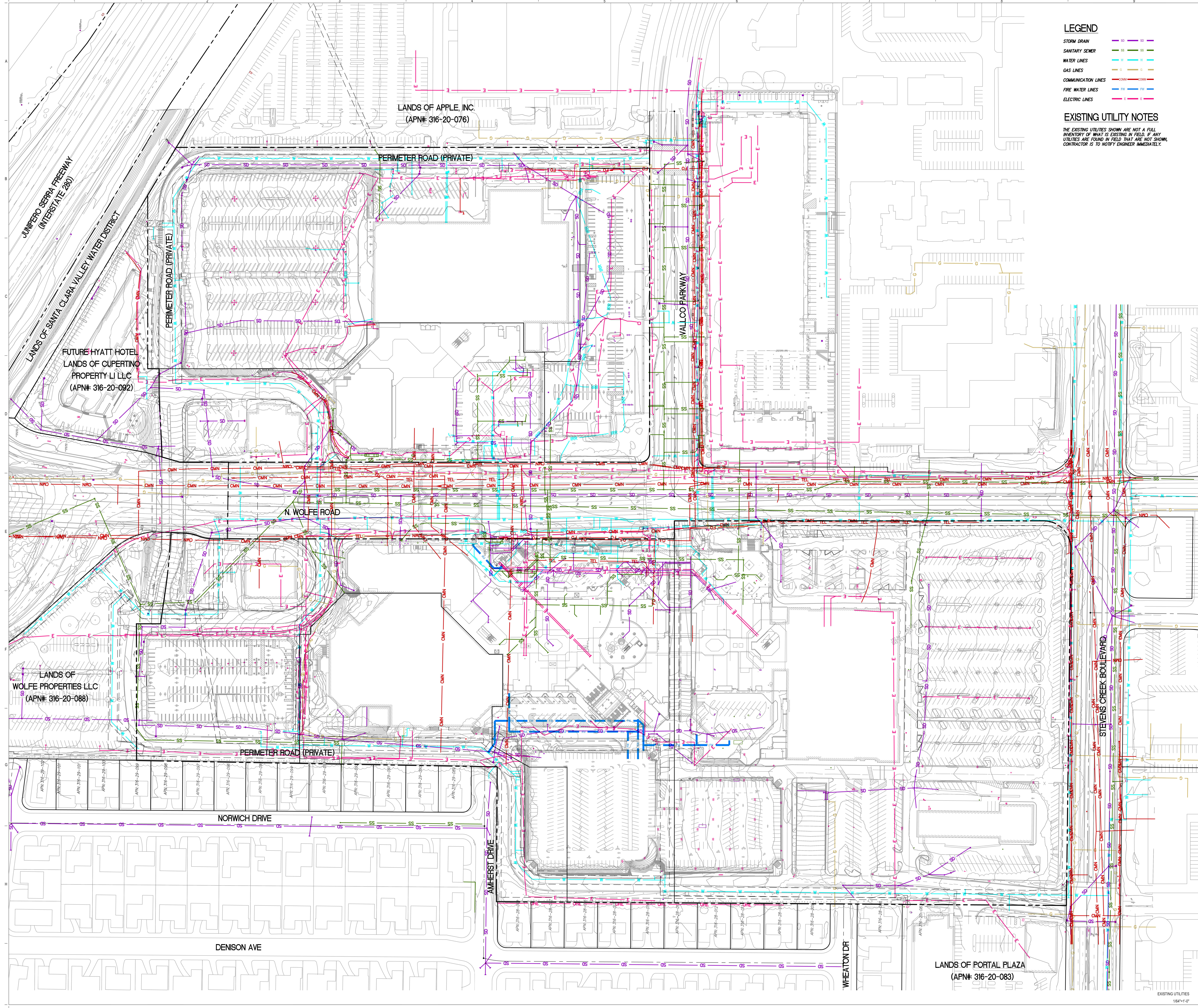

LANDS OF APPLE, INC.
(APN# 316-20-076)

FUTURE HYATT HOTEL
LANDS OF CUPERTINO
PROPERTY LI LLC
(APN# 316-20-092)

LANDS OF
WOLFE PROPERTIES LLC
(APN# 316-20-088)

LANDS OF PORTAL PLAZA
(APN# 316-20-083)

EXISTING UTILITIES
164"x11'0"