

MATCHLINE - SEE SHEET TM5.4

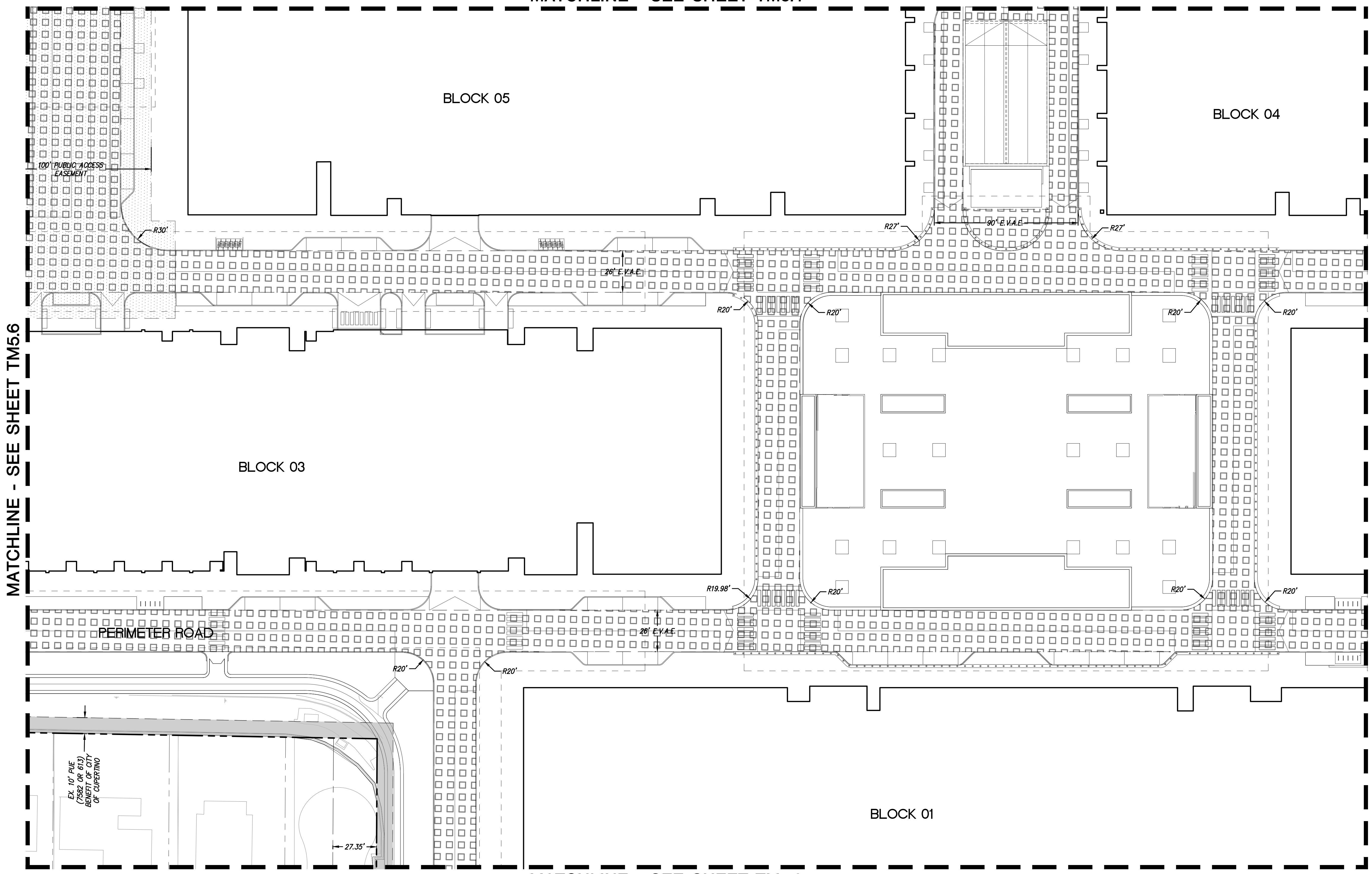

- LEGEND**
- PROPOSED PROPERTY LINE
  - - - ADJACENT PROPERTY LINE
  - - - STREET CENTERLINE (BASED ON CITY MONUMENTATION)
  - - - EASEMENT LINE
  - /// RELINQUISHED INGRESS/ EGRESS RIGHTS TO ADJACENT PROPERTIES
  - ▨ PUBLIC UTILITY/SERVICE EASEMENT (P.U.E.)/(P.S.E.)
  - ▩ PUBLIC ACCESS EASEMENT (P.A.E.)
  - ▧ SANITARY SEWER EASEMENT
  - ▦ WATER EASEMENT
  - ▤ AIR RIGHTS EASEMENT
  - ▥ STORMWATER MANAGEMENT FACILITY EASEMENT
  - ▣ VEHICULAR AND PEDESTRIAN INGRESS AND EGRESS EASEMENT
  - ▢ VEHICULAR TUNNEL EASEMENT
  - COLUMNS, SUPPORTS, AND FOOTINGS EASEMENT
  - PG&E EASEMENT
  - ▤ EMERGENCY VEHICLE ACCESS EASEMENT (E.V.A.E.)

MATCHLINE - SEE SHEET TM5.6

MATCHLINE - SEE SHEET TM5.8

MATCHLINE - SEE SHEET TM5.9

NO PART OF THIS DOCUMENT MAY BE REPRODUCED IN ANY FORM INCLUDING PHOTOCOPY, RECORDING OR ANY INFORMATION RETRIEVABLE AND STORAGE SYSTEM, WITHOUT PERMISSION IN WRITING FROM SANDIS.

**SANDIS** CIVIL ENGINEERS SURVEYORS PLANNERS  
 1700 S. Winchester Blvd, Suite 200, Campbell, CA 95008 | P. 408.636.0900 | F. 408.636.0999 | www.sandis.net  
 SILICON VALLEY TRI-VALLEY CENTRAL VALLEY SACRAMENTO EAST BAY/SF

DATE: 03/23/2022	DATE: MARCH 23, 2022
SCALE: 1"=30'	
DRAWN BY: SP	
APPROVED BY: ND	
DRAWING NO.: 215028	
	KELLY S. JOHNSON P.L.S. NO. 9126, EXPIRES 9-30-22

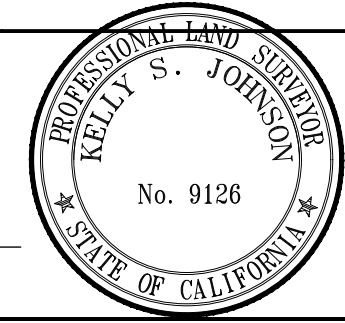

No.	REVISION/ISSUE	DATE	BY
REV-0	SB-35 DEVELOPMENT APPLICATION	03/27/2018	ND
REV-1	SB-35 APPLICATION REVISIONS	08/06/2018	ND
REV-2	SB-35 APPLICATION CONFORM SET	09/15/2018	ND
REV-3	SB-35 MODIFICATION DOCUMENTS	03/23/2022	ND

PUBLIC AND PRIVATE  
 EASEMENTS, DIMENSIONS AND BOUNDARIES

TENTATIVE SUBDIVISION MAP  
 VALLCO TOWN CENTER  
 CUPERTINO CALIFORNIA

SHEET  
**TM5.7**  
 OF 73 SHEETS  
 Copyright © 2018 by Sandis

File: S:\215028\4 ENGINEERING\2 PLAN SETS\3 SHEET SET\TENTATIVE MAP\TM-5 EASEMENTS AND DIMENSIONS.dwg Date: Mar 21, 2022 - 5:05pm, Isolis