

THE RISE

OWNER - VALCO PROPERTY OWNER LLC
 200 EL CAMINO REAL, SUITE 410, PALO ALTO, CA 94306
 T. 650-344-1500

ARCHITECTURE - RAFAEL VINOLY ARCHITECTS
 375 PEARL STREET, 31ST FLOOR, NEW YORK, NY 10038
 T. 212-924-5960

ARCHITECTURE - RAFAEL VINOLY ARCHITECTS
 1023 N. WOLFE ROAD, CUPERTINO, CA 95014
 T. 408-527-7000

LANDSCAPE ARCHITECTURE - OLIN PARTNERSHIP LTD.
 1617 JOHN F. KENNEDY BLVD, SUITE 1900, PHILADELPHIA, PA 19103
 T. 215-440-0039

CIVIL - SANDIS CIVIL ENGINEERS SURVEYORS PLANNERS, INC.
 1700 S. WINCHESTER BLVD, SUITE 200, CAMPBELL, CA 95008
 T. 408-638-0900

TRAFFIC - KIMLEY-HORN AND ASSOCIATES, INC.
 100 W. SAN FERNANDO STREET, SUITE 250, SAN JOSE, CA 95113
 T. 559-804-1130

LIGHTING DESIGN - ONE LUX STUDIO
 158 WEST 29TH STREET, 10TH FLOOR, NEW YORK, NY 10001
 T. 212-201-5758

SCENIC & WAYFINDING - EXIT DESIGN
 725 N. 4TH STREET, PHILADELPHIA, PA 19123
 T. 215-561-1990

PARKING ENGINEERING - WATRY DESIGN, INC.
 2099 GATEWAY PLACE, SUITE 550, SAN JOSE, CA 95110
 T. 408-362-7900

FOOD SERVICE, WASTE MANAGEMENT & LOGISTICS - CMI LITTLE
 156 2ND STREET, SAN FRANCISCO, CA 94105
 T. 415-922-5900

- LEGEND**
- PROPERTY LINE
 - PROPERTY LINE AFTER DEDICATION
 - - - GARAGE EXTENTS
 - ▭ STRUCTURE
 - ▭ STRUCTURE ABOVE
 - ▭ UNDERSTORY PLANTING

NOTES:

1. REFERENCE SHEET P-0607 FOR PLANTING PALETTE

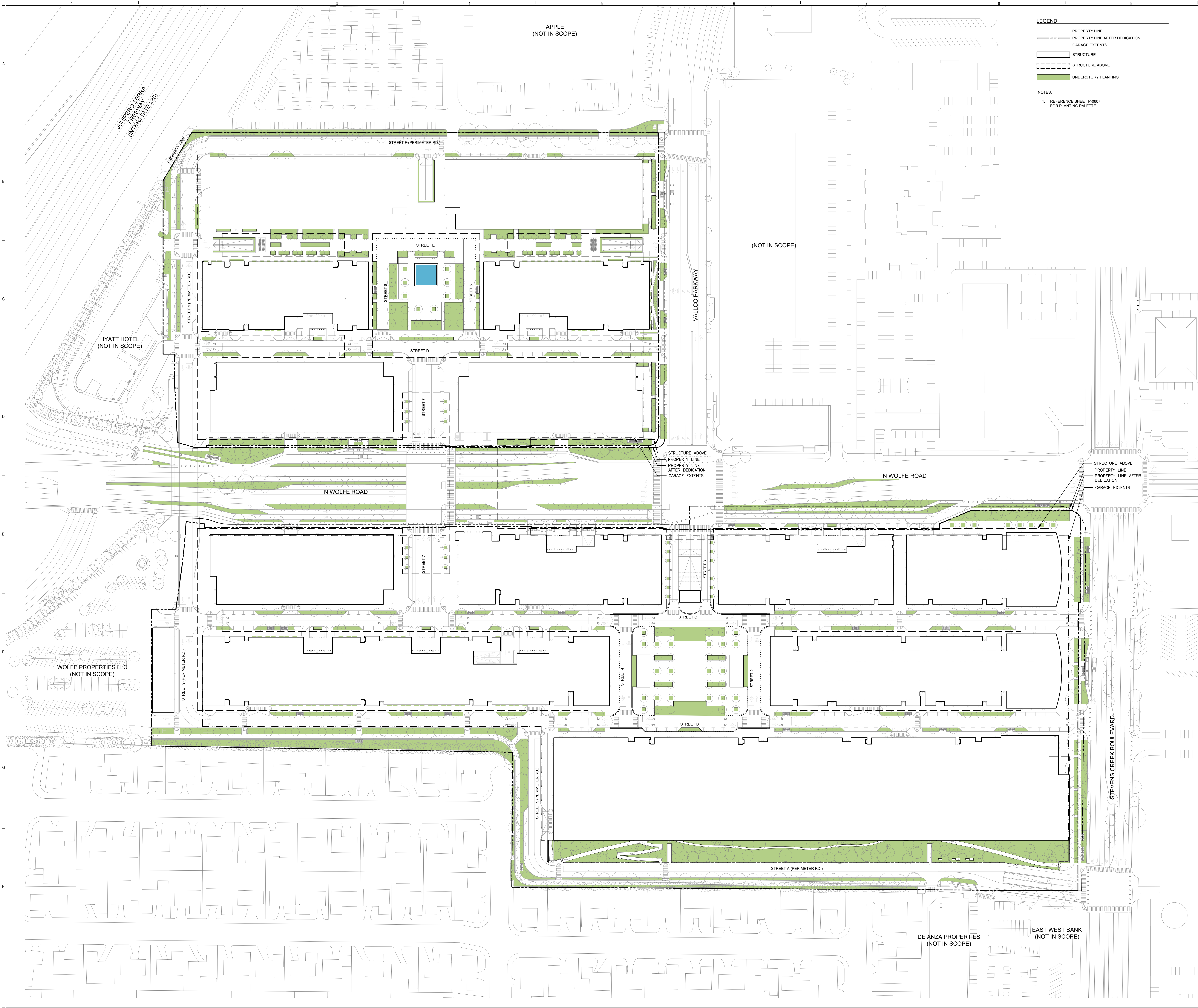

NOT FOR CONSTRUCTION

STAMP / SIGNATURE

DISCLAIMER
 THE ARCHITECT / ENGINEER SHALL HAVE NO RESPONSIBILITY FOR ANY LIABILITY, LOSS, COST, DAMAGE OR EXPENSE ARISING FROM OR RELATING TO ANY USE OF THIS DOCUMENT FOR ANY PURPOSE OTHER THAN ITS INTENDED PURPOSE ON THIS PROJECT. THIS DOCUMENT IS TO BE CONSIDERED IN CONJUNCTION WITH ALL RELATED DOCUMENTATION. ANY DISCREPANCIES IDENTIFIED IN THIS DOCUMENT MUST BE REPORTED IMMEDIATELY TO THE ARCHITECT BEFORE PROCEEDING. CONTRACTORS MUST VERIFY ALL DIMENSIONS PRIOR TO PROCEEDING WITH ANY WORK. ONLY FOUR-DIGIT DIMENSIONS ARE TO BE USED FOR VERIFICATION.

SB-35 MODIFICATION APPLICATION

REV	DESCRIPTION	DATE
REV-0	SB-35 DEVELOPMENT APPLICATION	03/27/2018
REV-1	SB-35 APPLICATION - REVISIONS	07/31/2018
REV-2	SB-35 APPLICATION CONFORM SET	06/15/2018
REV-3	SB-35 MODIFICATION APPLICATION	03/23/2022

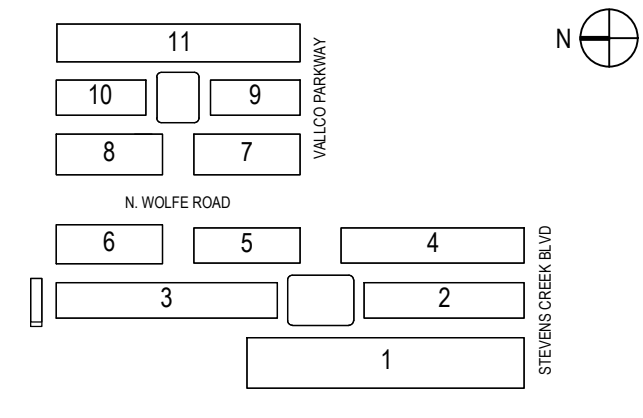

KEY PLAN AND NORTH ARROW

ARCHITECT'S PROJECT NUMBER 708.012

IF THIS DRAWING IS NOT 36"x48" IT IS A REDUCED PRINT. REFER TO GRAPHIC SCALE

SCALE 1/8" = 1'-0"

PLANTING PLAN STREET LEVEL - GROUNDCOVERS

SHEET TITLE

P-0605

SHEET NUMBER

© 2022 RAFAEL VINOLY ARCHITECTS P&A