

PRELIMINARY WASTE MANAGEMENT PLAN

The RISE

(Formerly known as Vallco Town Center)
Cupertino, California

Issued: 22 August 2018
Revised: 23 March 2022

Table of Contents

- 1.1 Introduction
- 1.2 Intent of this Document
- 1.3 Executive Summary
- 1.4 Expected Waste Streams
- 1.5 Preliminary Waste Management Strategy
 - 1.5.1 – Overview –Waste Centers (WC)
 - 1.5.2 – Residential
 - 1.5.3 – Retail
 - 1.5.4 – Office
 - 1.5.5 – Garden-Roof Top and Public Areas
- 1.6 Waste Generation Estimate
- 1.7 Third Party Hauler
- 1.8 Preliminary Waste Equipment and Space Program

1.1 INTRODUCTION

The Rise ("Project") is a redevelopment project that will completely re-develop the former Vallco Mall. The project consists of a mixed-use retail, office and residential facility that consists of 11 "blocks" / buildings which are interconnected through pedestrian walk-ways and includes a rooftop park.

The following report provides a preliminary Waste Management Plan for servicing this 50-acre site based on a preliminary estimate of waste generation, a conceptual program for waste handling systems, and equipment and space program for the Project in Cupertino, Ca.

1.2 INTENT OF THIS DOCUMENT

This Preliminary Waste Management Plan document is intended to provide the City of Cupertino Planning, Public Works, and Environmental Programs with an understanding of the preliminary loading, estimated size allocations, and different service strategies intended for the waste management of the Vallco site.

The applicant met on July 31, 2018 with Public Works, Environmental Programs, and Recology to review these materials to supplement the SB 35 Planning Application. A follow-up meeting with Recology to review the modified design application occurred on March 2, 2022 with a follow-up letter from Recology on March 3, 2022 taking no exception to the design changes.

A finalized Waste Management Plan indicating actual sizes, generation rates, equipment, and final systems will be submitted for review at the time of building permits. The preliminary and final solid waste and recycling planning shall follow all applicable California State and local Cupertino Municipal Codes and goals for recycling, including state Assembly Bills AB341, AB939 and AB1826, and City of Cupertino Municipal Codes 6.24 and 9.16.

1.3 EXECUTIVE SUMMARY

Given the nature of the Project site, the proposed uses, and the square footage of Project programs outlined in the SB 35 Planning Application drawings, wastes will be generated from residences, commercial retail tenants, offices, facility maintenance, plazas / garden / park area, parking, and general street / walk-ways.

These wastes will be collected and transported vertically in building cores through a combination of trash chutes and / or service elevators to storage rooms in the ground floor or basement based on the type of waste collected. From these locations, they will be collected by the operations personnel and transported horizontally to either a waste terminal or a trash loading dock.

It is from these locations that the City's contracted third-party hauler, Recology, for principal waste streams as well as additional private haulers as required for some specialty wastes will remove the waste and transport it to the appropriate off-site facility.

1.4 EXPECTED WASTE STREAMS

The principle waste streams which volume is significant enough to justify larger compactor-container equipment include the following:

1. General Trash
2. Organic Wastes

3. Commingled Recyclables (single-stream plastics, glass, metals/cans, clean paper)
4. Cardboard

In addition, specialty waste streams that will be staged for pick-up in carts, dumpster bins, secured cage/room, hazardous or flammable cabinets, etc. These include:

1. E-Waste – print cartridges, computers, electronic cords, phones, etc.
2. Donatable Materials – clothing, household items, furniture, non-perishable food, etc.
3. Recyclable Hazardous Waste - batteries (particularly lithium based which are increasingly mandated for separation from landfill), light bulbs, cooking oil, etc.
4. Non-Recyclable Hazardous Waste – paints, aerosols cans, chemicals, hazardous oils, bio-medical / sharps (needles) waste, etc.

1.5 PRELIMINARY WASTE MANAGEMENT STRATEGY

1.5.1 Overview – West Side Residential and Retail Waste Terminal

The overall principle strategy is to efficiently collect waste streams from disparate locations across the project site vertically into easily accessible centralized locations per block in back-of house ground and basement storage rooms and then horizontally transport the materials to a small number of centralized pick-up locations for waste haulers.

There are multiple reasons for this, including reducing hauler costs, efficiencies generated by utilizing larger collection / staging equipment and areas, establishing central soiled dock locations resulting in better hygienic control (including centralized trash can / cart washing), reducing truck transport to / from and on-site, etc.

A Waste Center" (WC), that serves the residential and retail waste on the West-side of Wolfe Road is located in Block 3. A smaller Waste Center serving residential buildings on the East Side is located in Block 10.

Diagram 1.5.1.1 –Waste Center

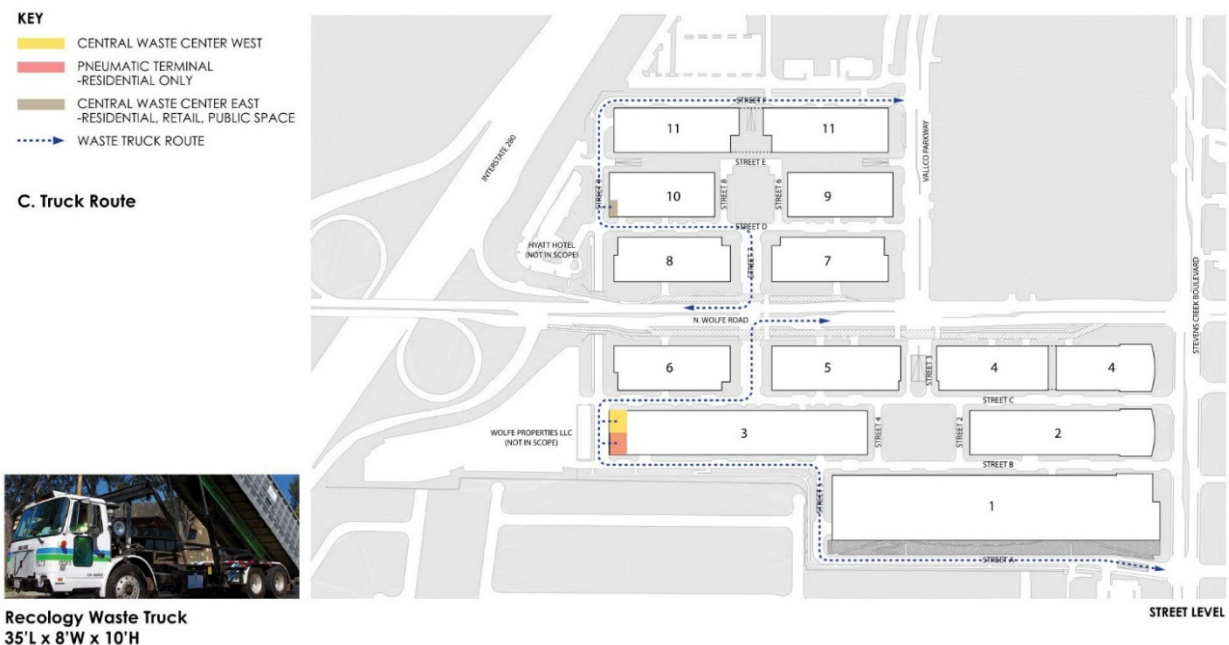

Each block will use a combination of chutes and service elevators to vertically transport waste materials to the basement or ground floor level where they will be aggregated in carts designated by waste type.

Each program (residential, office, and retail) will be separated in the below-grade and above-grade staging areas.

Roof-top public areas will be transported by hand, down service elevators and will share centralized compactor-containers and staging areas.

Diagram 1.5.1.2 – West Side Residential at Basement Level 1 West Side

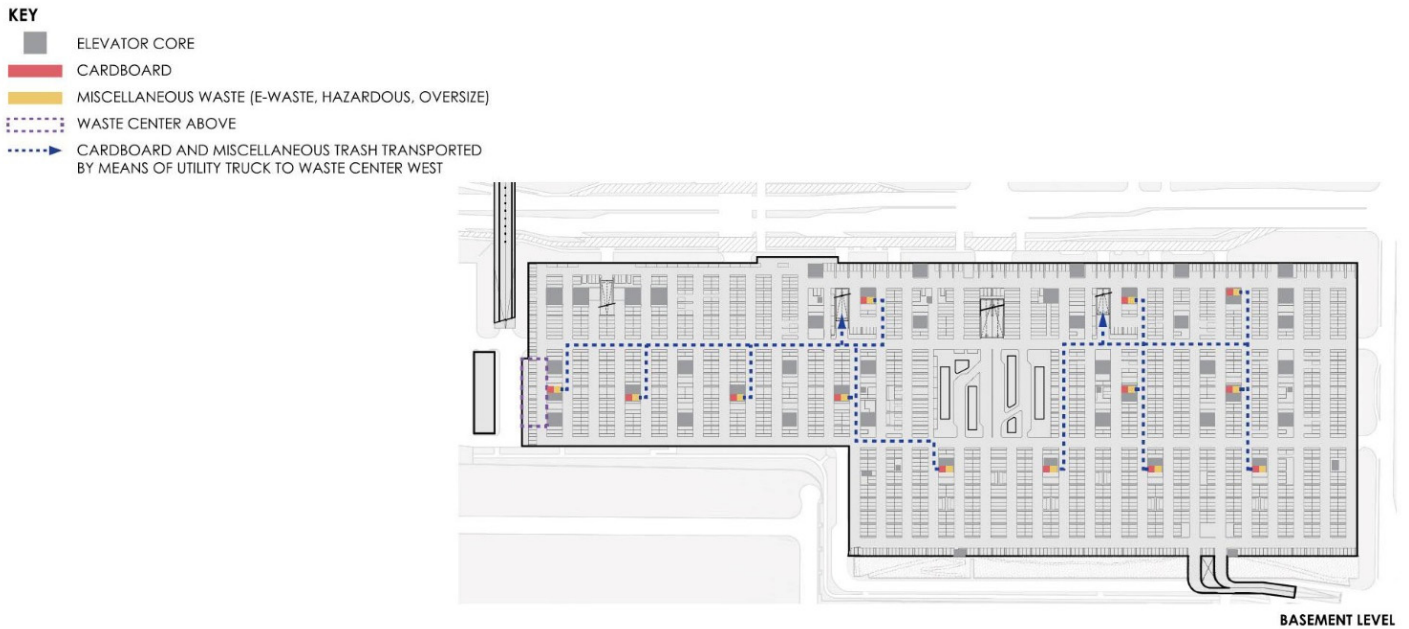

Once the waste has been transported to the central waste terminals, it will be compacted and prepared for off-haul by either the City of Cupertino's third-party hauler, Recology, or in the case of some of the specialty waste, private haulers.

1.5.2 Residential Waste Strategy (West Side)

Residences on the west side will utilize a system of vertical chutes in trash rooms located on each floor that are connected to a Pneumatic Waste System (PWS) for the principle waste streams of (1) General Trash, (2) Commingled Recyclables (plastics, cans, mixed paper), and (3) Organic Wastes.

The PWS is an automated and sealed system with intake doors to compactor containers at west side Central Waste Terminal in Block 3. At the bottom of each inlet pipe are valve rooms where wastes are temporarily held – the system is not under continuous pressure.

Once substantial waste has been collected in the valve chamber, or on a scheduled run, the waste bags are pneumatically sent direct to the respective compactor container for each waste type.

Diagram 1.5.2.1 – Residential Section of Chutes and Service Elevators West Side

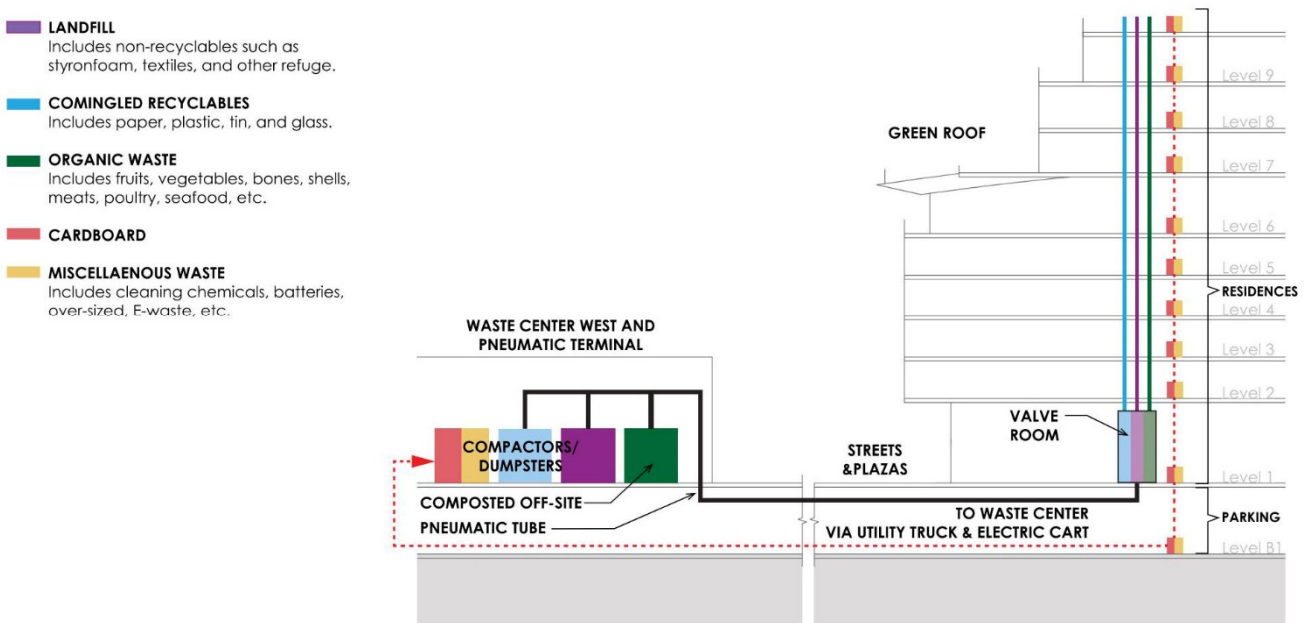

Diagram 1.5.2.2 – Example of Pneumatic Waste System Valve Room



During rare times when the PWS is off-line for maintenance, the waste streams will be handled manually through the trash staging rooms and then transported manually to the WC the same as retail, park, and office wastes.

There will be additional specialty wastes, including glass, cardboard, non-hazardous recyclables, and hazardous wastes, are collected in smaller bins in the PWS intake rooms on each floor and taken manually to the west side waste terminal by environmental / janitorial services.

Finally, there will be specific trash rooms on basement level accessible specifically by residents for bulk and specialty wastes. The specialty wastes are put into towable collection carts for semi-automated transport by tug to staging area under each WC, and then manually taken to staging rooms/areas on both the Basement Level and First Floor soiled dock.

Diagram 1.5.2.3 – Residential Plan at Basement Staging Areas

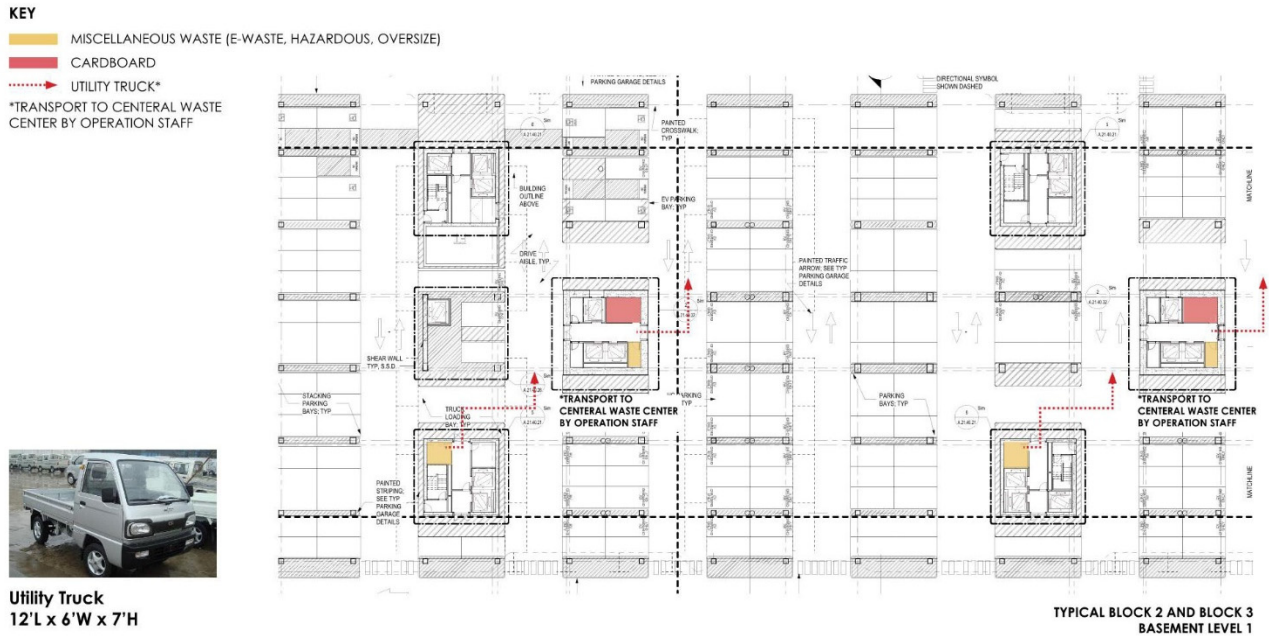

1.5.2 Residential Waste Strategy (East Side)

Residences on the east side will utilize a system of vertical chutes in trash rooms located on each floor that are connected to bin / cart receiving at the basement level for the principle waste streams of (1) General Trash, (2) Commingled Recyclables (plastics, cans, mixed paper), and (3) Organic Wastes.

There will be additional specialty wastes, including glass, cardboard, non-hazardous recyclables, and hazardous wastes, are collected in smaller bins in the trash rooms on each floor and taken manually to collection rooms at the basement level by environmental / janitorial services.

Finally, there will be specific trash rooms on basement level accessible specifically by residents for bulk and specialty wastes. The specialty wastes are put into towable collection carts for semi-automated transport by tug to staging area under each WC, and then manually taken to staging rooms/areas on both the Basement Level and First Floor soiled dock.

1.5.3 Retail Waste Strategy

Retail wastes will be collected at point of generation by individual tenants and brought to ground floor level trash rooms for staging. A tug system will take towable carts from the trash rooms to staging area at waste center, and then manually taken to staging rooms / areas for specialty wastes or direct to compactor-containers for the principle waste streams removal.

Principle waste types, including (1) General Trash, (2) Commingled Recyclables, (3) Organics, and (4) Cardboard will be taken to compactor containers at each respective WC.

Diagram 1.5.3.1 – Retail Plan at Ground Floor Staging Areas



Diagram 1.5.3.2 – Retail Plan at Ground Floor Staging Areas to Waste Center

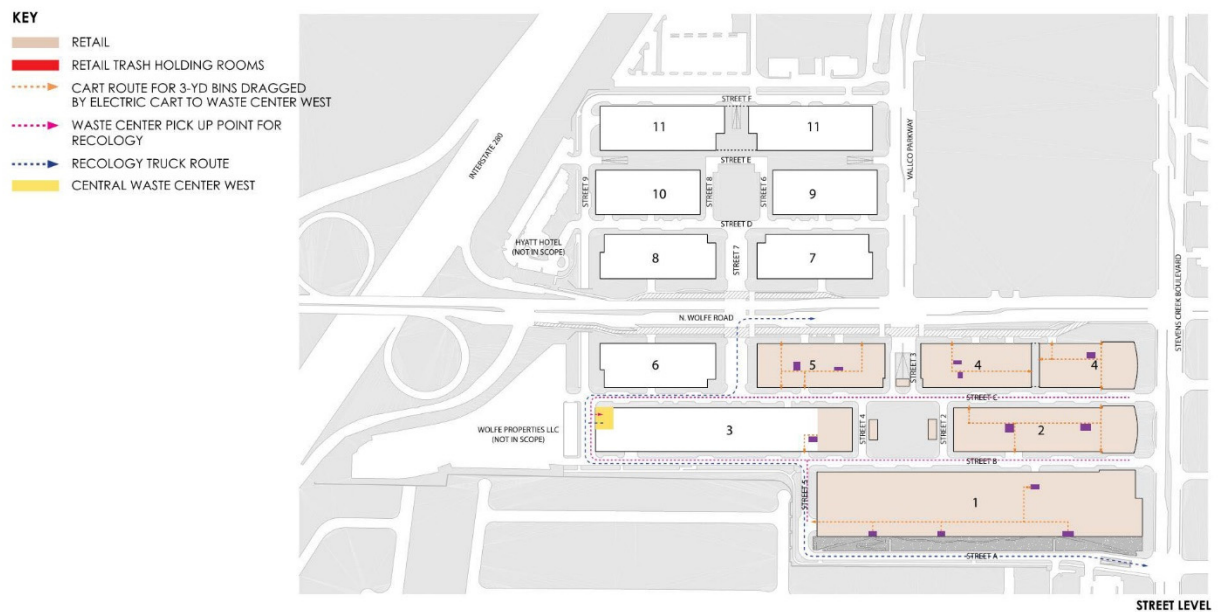

1.5.4 Offices Waste Strategy

Office wastes will be collected at point of generation by individual tenants / janitorial staff and brought to Ground Level Trash Rooms via service elevators for staging.

Diagram 1.5.4.1 – Office Section of Trash Collection at Service Elevators

- LANDFILL**
Includes non-recyclables such as styrofoam, textiles, and other refuse.
- COMINGLED RECYCLABLES**
Includes paper, plastic, tin, and glass.
- ORGANIC WASTE**
Includes fruits, vegetables, bones, shells, meats, poultry, seafood, etc.
- CARDBOARD**
- MISCELLANEOUS WASTE**
Includes cleaning chemicals, batteries, over-sized, E-waste, etc.
- TRASH PICK UP AT LOADING DOCK**

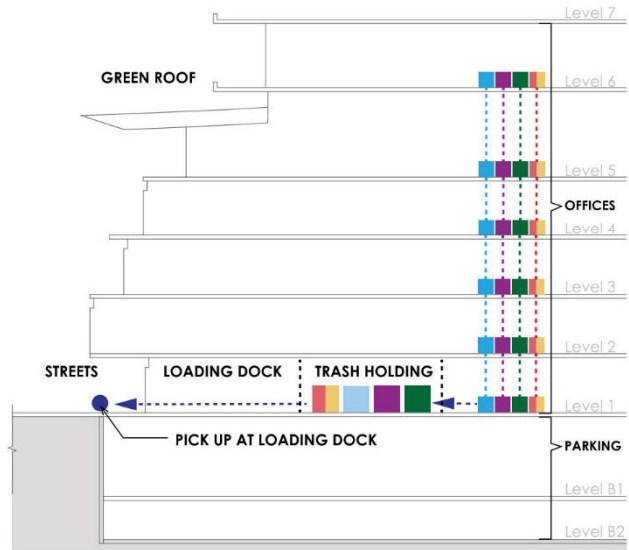
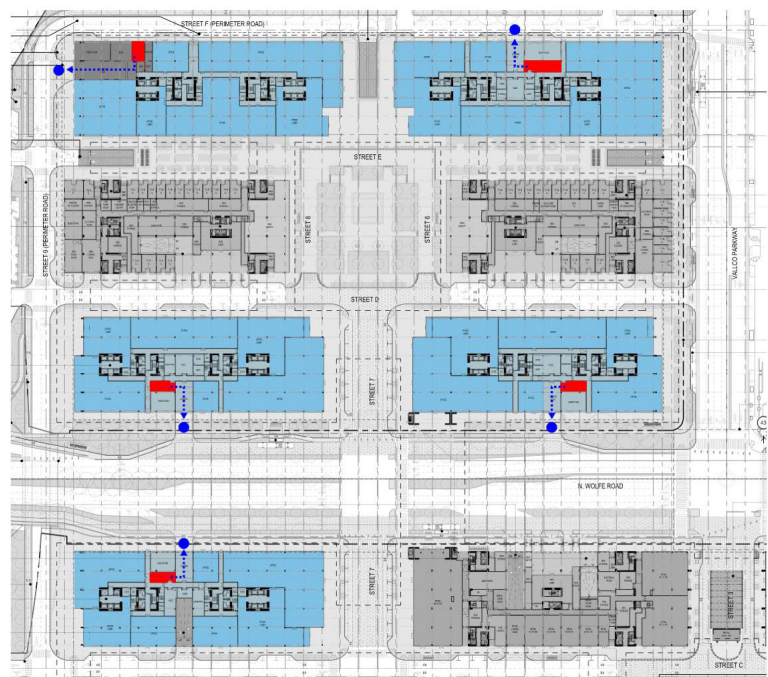

Diagram 1.5.4.2 – Office Plan at Ground Level Staging Areas

- KEY**
- OFFICE
 - LOCAL TRASH HOLDING ROOM EACH BUILDING AT GRADE LEVEL
 - COLLECTION POINT AT LOADING BLOCK



Trash will be stored in at-grade trash rooms adjacent to the loading docks in each office building where upon it will be removed by Recology and / or third-party handlers for e-waste, confidential, or hazardous waste.

Principle waste types, including (1) General Trash, (2) Commingled Recyclables, (3) Organics, and (4) Cardboard will be taken to compactor containers at each respective WC.

1.5.5 Garden-Roof Top and Public Areas Waste Strategy

Garden-roof top and public area wastes (street, parking) will be collected at point of generation by facility maintenance and either taken direct to the WC or brought to Basement Level Trash Rooms.

For wastes staged in basement trash rooms, a Tug system will take towable carts from the Trash Rooms to staging area under each WC, and then manually taken to staging rooms/areas on both the Basement Level and First Floor soiled dock.

Principle waste types, including (1) General Trash, (2) Commingled Recyclables, (3) Organics, and (4) Cardboard will be taken to compactor containers at each respective WC and put into hopper for compaction.

1.6 WASTE GENERATION ESTIMATE

See Tables 1 and 2 for the estimated volumes of general trash, recyclables, hazardous and other specialty wastes that will be generated from residents and commercial facilities of retail and offices. The provided estimate is utilized as basis for waste area design and equipment/system planning.

Actual waste diversion to landfill can increase/decrease based on the goals and effectiveness to carry out recycling programs by facility management and individual tenants and residents.

Total expected waste volume to be generated is estimated to be 1,859 cubic yards per week. Of this volume it is estimated for system planning that 1,053 cubic yards to be diverted on site from general landfill trash through recycling streams.

TABLE 1 – PRELIMINARY WASTE GENERATION PER BLOCK

Summary of the Waste Generation Estimate volumes by Block / Building

WASTE SUMMARY	Total Waste Generation Estimate (CY) per week	Total Waste Diversion Estimate (CY/Wk)	General Trash Uncompacted (CY/Wk)	General Trash Compacted 3:1 Ratio (CY/Wk)
WEST SIDE				
BLOCK 1	154.0	70.5	83.5	27.8
BLOCK 2	203.5	106.5	97.0	32.3
BLOCK 3	264.0	150.5	113.5	37.8
BLOCK 4	210.8	106.3	104.5	34.8
BLOCK 5	150.1	80.2	69.9	23.3
BLOCK 6	61.8	35.2	26.6	8.9
<i>West Subtotal</i>	<i>1,044.2</i>	<i>549.1</i>	<i>495.0</i>	<i>165.0</i>
EAST SIDE				
BLOCK 7	68.4	39.0	29.4	9.8
BLOCK 8	62.6	35.7	26.9	9.0
BLOCK 9	157.5	91.0	66.5	22.2
BLOCK 10	155.3	89.8	65.5	21.8
BLOCK 11	258.1	165.2	92.9	31.0
<i>East Subtotal</i>	<i>701.8</i>	<i>420.5</i>	<i>281.3</i>	<i>93.8</i>
ROOFTOP / YARD	43.7	38.5	5.2	1.7
STREET / PATHWAYS (Level 1)	34.4	22.4	12.1	4.0
PARKING	34.9	22.7	12.2	4.1
<i>Rooftop / Street / Parking Subtotal</i>	<i>113.1</i>	<i>83.6</i>	<i>29.5</i>	<i>9.8</i>
Grand Total	1,859	1,053	806	269

TABLE 2 – PRELIMINARY RECYCLABLES PER BLOCK

Summary of the Recyclables breakdown by Block / Building

RECYCLABLES BREAK-DOWN	(1) Organics (CY/Wk)	(2) Corrugated Cardboard (CY/Wk)	(3) Commingled Recyclable (CY/Wk)	(4) Donatable / Bulky Materials (CY/Wk)	(5) E-Waste & Recyclable Hazardous (CY/Wk)	(6) Non-Recyclable Hazardous (CY/Wk)
WEST SIDE						
BLOCK 1	16.8	15.4	26.7	6.9	3.1	1.5
BLOCK 2	31.0	20.3	41.2	7.8	4.1	2.0
BLOCK 3	47.5	26.4	60.0	8.7	5.3	2.6
BLOCK 4	29.6	21.1	40.9	8.5	4.2	2.1
BLOCK 5	25.6	15.0	29.0	6.1	3.0	1.5
BLOCK 6	11.1	6.2	13.6	1.2	2.5	0.6
<i>West Subtotal</i>	161.6	104.4	211.4	39.1	22.1	10.4
EAST SIDE						
BLOCK 7	12.3	6.8	15.0	1.4	2.7	0.7
BLOCK 8	11.3	6.3	13.8	1.3	2.5	0.6
BLOCK 9	28.4	15.8	37.5	4.6	3.2	1.6
BLOCK 10	28.0	15.5	37.1	4.6	3.1	1.6
BLOCK 11	46.5	38.7	56.8	10.3	10.3	2.6
<i>East Subtotal</i>	126.3	83.1	160.2	22.1	21.8	7.0
ROOFTOP / YARD	33.3	-	5.2	-	-	-
STREET / PATHWAYS (Level 1)	10.3	-	12.1	-	-	-
PARKING	10.5	-	12.2	-	-	-
<i>Rooftop / Street / Parking Subtotal</i>	54.1	-	29.5	-	-	-
Grand Total	342.0	187.5	401.1	61.2	43.9	17.5

(1) Organic Wastes include items such as fruits, vegetables, eggs, paper egg containers, plants, coffee grounds, filters, tea bags, soiled paper products (napkins, towels), daily on-site yard maintenance, etc.

(2) Corrugated Cardboard

(3) Co-mingled Recyclables include plastic, cans, glass, clean mixed paper.

(4) Donatable Materials include items such as clothing, shoes, sporting equipment, household items, non-perishable foods, furniture, etc.

(5) E-Waste & Recyclable Hazardous Materials include print cartridges, computers, phones, electronic cords, batteries, light bulbs, cooking oil, etc.

(6) Non-Recyclable Hazardous Materials include paints, aerosol cans, chemicals, hazardous oils, medical waste, sharps (note: bio-hazardous and chemical waste requires special processing off-site)

1.7 THIRD PARTY WASTE HAULER

The local waste hauler for commercial and residential for this project will be Recology South Bay, which will handle general trash, cardboard, commingled recyclables (single stream), organic/compostable wastes, and other hazardous and non-hazardous specialty wastes.

There will be some private haulers for some of the specialty wastes, which may include cooking oil, donatable items, some hazardous and non-hazardous wastes, confidential waste, etc.

Yard waste collected by on-site daily landscape maintenance will be taken to the waste management centers and put into organics recycling stream. Off-site landscape vendors who provide maintenance services on regular basis will take their yard waste off-site directly to composting facility.

1.8 PRELIMINARY WASTE EQUIPMENT AND HANDLING PROGRAM

The following reviews the various waste types for handling and recommendations for major equipment and pick-up volumes.

General Trash:

Residential West – general trash will be vertically transported via gravity chute to basement level and then sent via pneumatic waste system (PWS) to compactor containers at Central Waste Terminal at Block 3.

Residential East – general trash will be vertically transported via gravity chute to 3-cubic yard bins at basement level and then moved manually through service elevators and corridors to Central Waste Terminal at Block 9.

Retail West – retail tenants take waste to Trash Staging Rooms; building maintenance moves bins and carts to Central Waste Center at Block 3. Bins are tipped to ~35-cubic yard compactor-container.

Offices West and East – general trash transported by tenants via service elevators and corridors to Trash Staging Rooms and placed into 3-cubic yard dumpster bins. Trash Staging Rooms located adjacent to each building's dock for Blocks 6, 7, 8, and 11. Option to use smaller compactor (e.g., vertical or horizontal compactor with hopper) for 3-cubic yard bins.

General Trash:

	WEST	EAST
Uncompacted CY per Wk	509.8	296.1
Compacted CY per Wk	169.9	98.7
Size Container CY	39	N/A
Pick-Up	~2 times / Wk each container	N/A
Area Requirement	2 truck bays	N/A
Dumpster Size CY	N/A	3.00
Pick-Up	N/A	3 / Wk
Estimated Uncompacted No. Dumpster Bins per Pick-Up	N/A	33
Estimated Compacted No. Dumpster Bins per Pick-Up	N/A	11

Note: Volumes include Parking, Street / Outdoor

Organic Waste:

Residential West – organic wastes will be vertically transported via gravity chute to basement level and then sent via pneumatic waste system (PWS) to compactor containers at Central Waste Terminal at Block 3.

Residential East – organics wastes will be vertically transported via gravity chute to 3-cubic yard bins at basement level and then moved manually through service elevators and corridors to Central Waste Terminal at Block 9.

Retail West – retail tenants take organic waste to Trash Staging Rooms; building maintenance moves bins and carts to Central Waste Center at Block 3. Bins are staged in conditioned room and moved to truck bay staging during pick-up period.

Offices West and East – organic waste is transported by tenants via service elevators and corridors to Trash Staging Rooms and placed into 2-cubic yard dumpster bins. Trash Staging Rooms located adjacent to each building's dock for Blocks 6, 7, 8, and 11.

Organics:

	WEST	EAST
Uncompacted CY per Wk	197.3	144.7
Size Container CY	39	N/A
Pick-Up <i>WEST RESIDENTIAL ONLY</i>	~1 times / Wk each container	N/A
Area Requirement	1 truck bay	N/A
Dumpster Size CY	2.00	2.00
Pick-Up	3 / Wk	3 / Wk
Estimated Uncompacted No. Dumpster Bins per Pick-Up	13	28

Note: Volumes include Parking, Street / Outdoor

Note: West Residential by Pneumatic System

Commingled Recycling:

Residential West – commingled recycling wastes will be vertically transported via gravity chute to basement level and then sent via pneumatic waste system (PWS) to compactor containers at Central Waste Terminal at Block 3.

Residential East – commingled recycling wastes will be vertically transported via gravity chute to 3-cubic yard bins at basement level and then moved manually through service elevators and corridors to Central Waste Terminal at Block 9.

Retail West – retail tenants take commingled recycling waste to Trash Staging Rooms; building maintenance moves bins and carts to Central Waste Center at Block 3. Bins are staged in the center and moved to truck bay staging during pick-up period.

Offices West and East – commingled recycling waste is transported by tenants via service elevators and corridors to Trash Staging Rooms and placed into 3-cubic yard dumpster bins. Trash Staging Rooms located adjacent to each building’s dock for Blocks 6, 7, 8, and 11.

Commingled:

	WEST	EAST
Uncompacted CY per Wk	226.1	175.0
Size Container CY	39	N/A
Pick-Up <i>WEST RESIDENTIAL ONLY</i>	~1 times / Wk each container	N/A
Area Requirement	1 truck bay	N/A
Dumpster Size CY	3.00	3.00
Pick-Up	3 / Wk	3 / Wk
Estimated Uncompacted No. Dumpster Bins per Pick-Up	11	26

Note: Volumes include Parking, Street / Outdoor
Note: West Residential by Pneumatic System

Cardboard:

Residential West – cardboard will be brought by residents to the basement level residential collection rooms for specialty wastes and placed into transport bins. Building maintenance will transport bins to the Central Waste Terminal at Block 3 and cardboard will be baled to pallets for later pick-up by hauler.

Residential East – cardboard will be brought by residents to the basement level residential collection rooms for specialty wastes and placed into transport bins. Building maintenance will transport bins to the Central Waste Terminal at Block 9 and cardboard will be baled to pallets for later pick-up by hauler.

Retail West – retail tenants take cardboard to Trash Staging Rooms; building maintenance moves bins to Central Waste Center at Block 3. Cardboard will be baled to pallets for later pick-up by hauler.

Offices West and East – cardboard is transported by tenants via service elevators and corridors to Trash Staging Rooms and placed into 3-cubic yard dumpster bins. Trash Staging Rooms located adjacent to each building's dock for Blocks 6, 7, 8, and 11. Cardboard will be baled to pallets for later pick-up by hauler.

Cardboard:

	WEST	EAST
Uncompacted CY per Wk	104.42	83.1
No. Pallets Compacted Cardboard	13	10
Pick-Up	1 / Wk	1 / Wk

Note: Volumes include Parking, Street / Outdoor

Donatable and Bulky Waste:

Residential West – donatable and bulky wastes will be brought by residents to the basement level residential collection rooms for specialty wastes and placed into transport bins or for larger items placed in open area. Building maintenance will transport items to the Central Waste Terminal at Block 3 for staging and periodic pick-up by hauler.

Residential East – donatable and bulky wastes will be brought by residents to the basement level residential collection rooms for specialty wastes and placed into transport bins or for larger items placed in open area. Building maintenance will transport items to the Central Waste Terminal at Block 9 for staging and periodic pick-up by hauler.

Retail West – retail tenants take donatable and bulky waste to Trash Staging Rooms; building maintenance moves items to Central Waste Center at Block 3 for periodic pick-up by hauler.

Offices West and East – donatable and bulky waste is transported by tenants via service elevators and corridors to Trash Staging Rooms and placed into 3-cubic yard dumpster bins or for larger items placed in open area. Trash Staging Rooms located adjacent to each building's dock for Blocks 6, 7, 8, and 11. Items will be periodically picked-up by hauler.

Donatable and Bulky Waste items require a mix of dumpster bins, carts, shelving, and open area for larger items.

Donatable & Bulky Waste Items:

	WEST	EAST
Uncompacted CY per Wk	39.1	22.1
Pick-Up	1 / Wk or as required	1 / Wk or as required
Estimated No. Dumpster Bins per Pick-Up	5	3

Note: Volumes include Parking, Street / Outdoor

Note: Estimated volume by Bin Pick-Up is approximately 40%. For other items areas are provided in plan for shelving and open area for larger items.

E-Waste and Recyclable Hazardous Waste:

Residential West – E-waste and recyclable hazardous wastes will be brought by residents to the basement level residential collection rooms for specialty wastes and placed into transport bins or carts. Building maintenance will transport items to the Central Waste Terminal at Block 3 for staging in bins, carts or smaller containers staged on shelving and periodic pick-up by hauler.

Residential East – E-waste and recyclable hazardous wastes will be brought by residents to the basement level residential collection rooms for specialty wastes and placed into transport bin or carts. Building maintenance will transport items to the Central Waste Terminal at Block 9 for staging in bins, carts or smaller containers staged on shelving and periodic pick-up by hauler.

Retail West – retail tenants take E-wastes and recyclable hazardous wastes to Trash Staging Rooms; building maintenance moves items to Central Waste Center at Block 3 for staging in bins, carts, or smaller containers staged on shelving for periodic pick-up by hauler.

Offices West and East – E-wastes and recyclable hazardous wastes is transported by tenants via service elevators and corridors to Trash Staging Rooms and placed into bins, carts, or smaller containers that are staged in bins, carts or smaller containers on shelving. Trash Staging Rooms located adjacent to each building's dock for Blocks 6, 7, 8, and 11. Items will be periodically picked-up by hauler.

E-waste and recyclable hazardous waste items require a mix of bins, carts and smaller containers on shelving. Adequate areas have been put into plans for this staging requirement.

Individual food retail tenants should also plan for recycling Used Cooking Oil.

E-Waste & Recyclable Hazardous Waste:

	WEST	EAST
Uncompacted CY per Wk	22.1	21.8
Pick-Up	1 / Wk or as required	1 / Wk or as required

Note: Items are separated by type at final staging area into combination of bins, carts, or smaller containers on shelving. Areas have been provided in plan.

Non-Recyclable Hazardous Waste:

Residential West – non-recyclable hazardous waste will be brought by residents to the basement level residential collection rooms for specialty wastes and placed into transport carts. Building maintenance will transport items to the Central Waste Terminal at Block 3 for staging in flammable cabinets or lockable carts depending on waste type for periodic pick-up by hauler.

Residential East – non-recyclable hazardous waste will be brought by residents to the g basement level residential collection rooms for specialty wastes and placed into transport bin or carts. Building maintenance will transport items to the Central Waste Terminal at Block 9 for staging in flammable cabinets or lockable carts depending on waste type for periodic pick-up by hauler.

Retail West – retail tenants take non-recyclable hazardous waste to Trash Staging Rooms; building maintenance moves items to Central Waste Center at Block 3 for staging in flammable cabinets or lockable carts depending on waste type for periodic pick-up by hauler.

Offices West and East – non-recyclable hazardous waste is transported by tenants via service elevators and corridors to Trash Staging Rooms and placed into flammable cabinets or lockable carts depending on the waste type for periodic pick-up by hauler. Trash Staging Rooms located adjacent to each building's dock for Blocks 6, 7, 8, and 11. Items will be periodically picked-up by hauler.

Adequate areas have been put into plans for this staging requirement.

Non-Recyclable Hazardous Waste:

	WEST	EAST
Uncompacted CY per Wk	10.4	7.0
Pick-Up	1~2 / Wk or as required	1~2 / Wk or as required

Note: Items are separated by type at final staging area into combination of flammable cabinets or lockable carts (latter for any biohazard). Areas have been provided in plan.

END OF REPORT