

MATCHLINE - SEE SHEET TM7.1

LEGEND

- PROPERTY LINE
- ADJACENT PROPERTY LINE
- STREET CENTERLINE
- EASEMENT LINE
- FLOW ARROW
- OVERLAND RELEASE
- WATER METER
- BACKFLOW PREVENTER
- SD --- STORM DRAIN LINE
- SS --- SANITARY SEWER LINE
- W --- WATER LINE
- JT --- JOINT TRENCH LINE
- COM --- COMMUNICATION LINE
- UNDERGROUND GARAGE LIMIT
- ELECTRICAL VAULT

- UTILITY NOTE**
- TRANSFORMERS TO BE LOCATED WITHIN THE BUILDING.
 - UTILITY DESIGN IS CONCEPTUAL. FINAL LOCATIONS, SIZES, NUMBER AND OTHER DETAILS TO BE DETERMINED AND APPROVED AT A LATER DATE IN CONSULTATION WITH THE CITY'S PUBLIC WORKS DEPARTMENT AND OTHER PERMITTING AUTHORITIES SUCH AS PG&E.
 - EVERY DOMESTIC WATER SERVICES WILL HAVE AN INDIVIDUAL SUBMETERS LOCATED WITHIN THE PODIUM FOOTPRINT. EXACT LOCATIONS LOCATIONS WILL BE CONFIRMED IN CONSULTATION WITH THE PLUMBING ENGINEER.
 - STORMWATER DESIGN AND TREATMENT WITHIN THE PUBLIC RIGHT-OF-WAY TO BE ADDRESSED DURING THE STREET IMPROVEMENT PERMIT PHASE.
 - ALL IMPROVEMENTS ON ADJACENT PROPERTIES TO BE COORDINATED AND APPROVED (AS NECESSARY) BY PRIVATE AGREEMENT.
 - BACKFLOW PREVENTERS TO BE LOCATED WITHIN THE BUILDING.

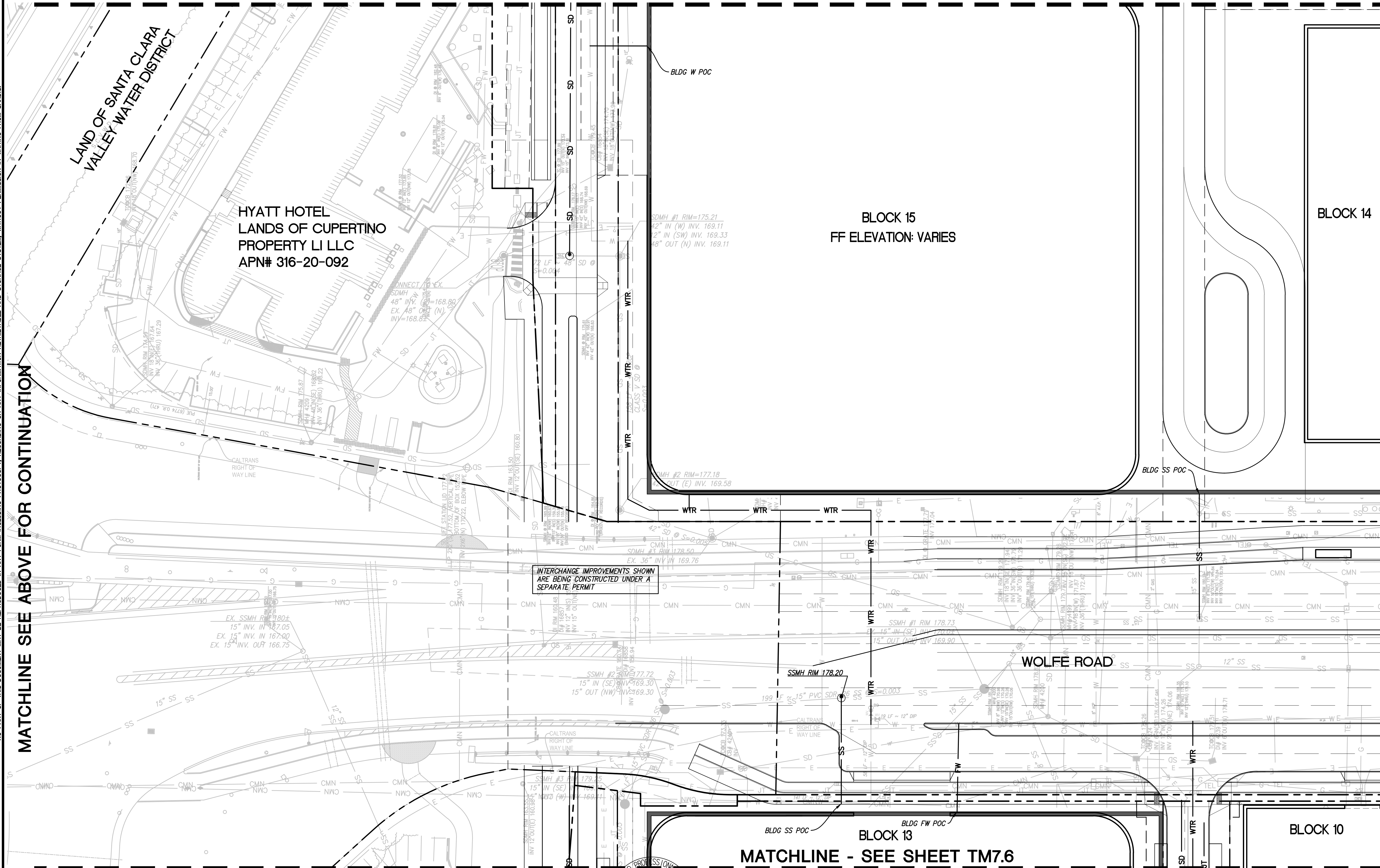

NO PART OF THIS DOCUMENT MAY BE REPRODUCED IN ANY FORM INCLUDING PHOTOCOPY, RECORDING OR ANY INFORMATION RETRIEVABLE AND STORAGE SYSTEM, WITHOUT PERMISSION IN WRITING FROM SANDIS.

MATCHLINE SEE ABOVE FOR CONTINUATION

MATCHLINE - SEE SHEET TM7.4

MATCHLINE - SEE SHEET TM7.6

	BUILD ON. SANDIS.NET	DATE: 12/04/2023 SCALE: 1"=30' DRAWN BY: LS APPROVED BY: ND DRAWING NO.: 223237	DATE: DECEMBER 4, 2023 CHAD J. BROWNING R.C.E. NO. 68315, EXPIRES 9-30-25		<table border="1" style="width: 100%; border-collapse: collapse;"> <thead> <tr> <th>No.</th> <th>REVISION/ISSUE</th> <th>DATE</th> <th>BY</th> </tr> </thead> <tbody> <tr> <td>REV-1</td> <td>SB-35 APPLICATION REVISIONS</td> <td>08/06/2018</td> <td>ND</td> </tr> <tr> <td>REV-2</td> <td>SB-35 APPLICATION CONFORM SET</td> <td>09/15/2018</td> <td>ND</td> </tr> <tr> <td>REV-3</td> <td>SB-35 MODIFICATION DOCUMENTS</td> <td>03/23/2022</td> <td>ND</td> </tr> <tr> <td>REV-4</td> <td>SB-35 MODIFICATION APPLICATION</td> <td>05/27/2022</td> <td>ND</td> </tr> <tr> <td>REV-5</td> <td>SB-35 MODIFICATION DOCUMENTS</td> <td>12/04/2023</td> <td>ND</td> </tr> </tbody> </table>	No.	REVISION/ISSUE	DATE	BY	REV-1	SB-35 APPLICATION REVISIONS	08/06/2018	ND	REV-2	SB-35 APPLICATION CONFORM SET	09/15/2018	ND	REV-3	SB-35 MODIFICATION DOCUMENTS	03/23/2022	ND	REV-4	SB-35 MODIFICATION APPLICATION	05/27/2022	ND	REV-5	SB-35 MODIFICATION DOCUMENTS	12/04/2023	ND	UTILITY PLAN	TENTATIVE SUBDIVISION MAP VALLCO TOWN CENTER CUPERTINO CALIFORNIA	SHEET TM7.3 OF 74 SHEETS
	No.	REVISION/ISSUE	DATE	BY																												
REV-1	SB-35 APPLICATION REVISIONS	08/06/2018	ND																													
REV-2	SB-35 APPLICATION CONFORM SET	09/15/2018	ND																													
REV-3	SB-35 MODIFICATION DOCUMENTS	03/23/2022	ND																													
REV-4	SB-35 MODIFICATION APPLICATION	05/27/2022	ND																													
REV-5	SB-35 MODIFICATION DOCUMENTS	12/04/2023	ND																													
						Copyright © 2018 by Sandis																										