

NO PART OF THIS DOCUMENT MAY BE REPRODUCED IN ANY FORM INCLUDING PHOTOCOPY, RECORDING OR ANY INFORMATION RETRIEVABLE AND STORAGE SYSTEM, WITHOUT PERMISSION IN WRITING FROM SANDIS.

LANDS OF APPLE, INC.  
APN# 316-20-076

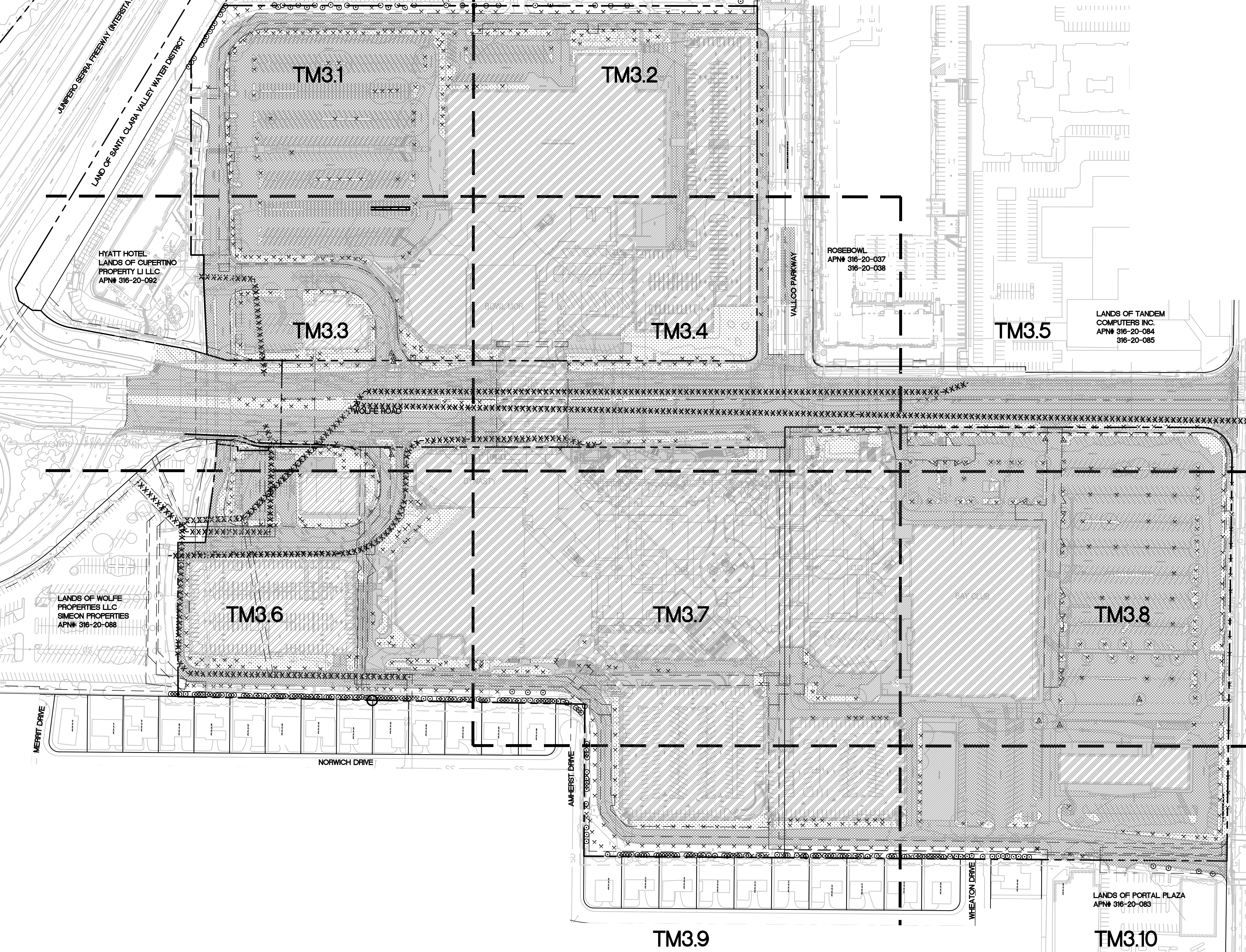

**NOTES:**  
1. SEE PLANNING PLANS FOR TREE DISPOSITION TREE COUNT. FINAL DISPOSITION OF TREES WITH THE EXACT NUMBER OF TREES TO BE REMOVED, KEPT AND TRANSPOSED ARE TO BE DETERMINE DURING THE FINAL SITE PLAN.

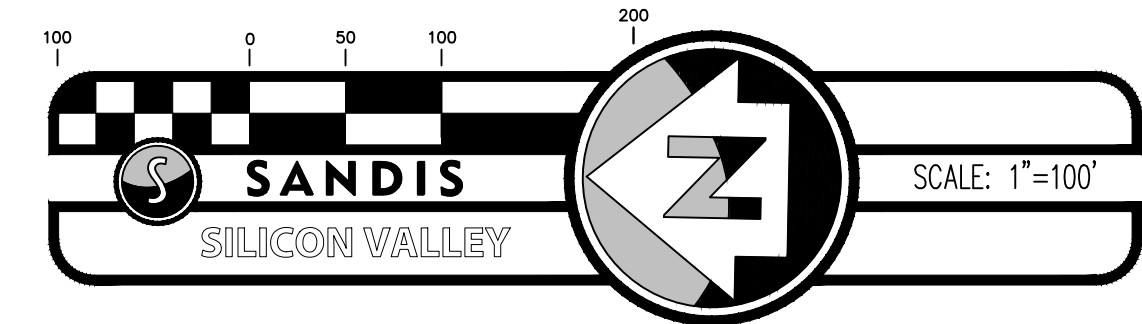

**BUILD ON.**  
SANDIS.NET

DATE: 12/04/2023  
SCALE: 1"=100'  
DRAWN BY: LS  
APPROVED BY: ND  
DRAWING NO.: 223237  
DATE: DECEMBER 4, 2023  
KELLY S. JOHNSON  
P.L.S. NO. 9126, EXPIRES 9-30-26

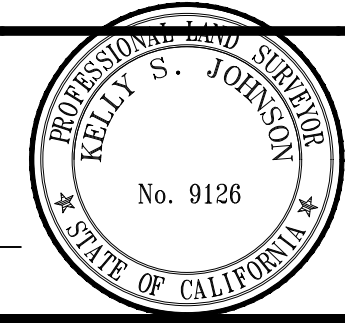

No.	REVISION/ISSUE	DATE	BY
REV-1	SB-35 APPLICATION REVISIONS	08/06/2018	ND
REV-2	SB-35 APPLICATION CONFORM SET	09/15/2018	ND
REV-3	SB-35 MODIFICATION DOCUMENTS	03/23/2022	ND

**OVERALL  
DEMOLITION AND  
TREE DISPOSITION PLAN**

**TENTATIVE SUBDIVISION MAP  
VALLCO TOWN CENTER  
CUPERTINO CALIFORNIA**

SHEET  
**TM3.0**  
OF 74 SHEETS  
Copyright © 2018 by Sandis