

**Client**  
VALCO PROPERTY OWNER LLC  
200 EL CAMINO REAL, SUITE 410  
PALO ALTO, CA 94306  
TEL: 650.344.1500

**Architecture**  
KOHN PEDERSEN FOX ASSOCIATES PC  
11 WEST 42ND STREET  
NEW YORK, NY 10036  
TEL: 212.877.6500

**Architecture**  
KOHN PEDERSEN FOX ASSOCIATES PC  
2 EMBARCADERO CENTER  
SAN FRANCISCO, CA 94111  
TEL: 415.944.5491

**Landscape Architecture**  
OLIN  
1617 JOHN F. KENNEDY BOULEVARD, SUITE 1900  
PHILADELPHIA, PA 19103  
TEL: 215.440.0030

**Civil**  
SANDIS  
170 S. WINCHESTER BOULEVARD, SUITE 200  
CAMPBELL, CA 95113  
TEL: 408.638.0900

**Lighting Design**  
ONE LUX STUDIO  
158 WEST 29TH STREET, 10TH FLOOR  
NEW YORK, NY 10001  
TEL: 212.201.5790

**Structure**  
DCI ENGINEERS  
135 MAIN STREET, SUITE 1800  
SAN FRANCISCO, CA 94109  
TEL: 415.781.1505

**MEP**  
MEYERS+ ENGINEERS  
98 BATTERY STREET, SUITE 500  
SAN FRANCISCO, CA 94111  
TEL: 415.432.8101

**Geotechnical**  
JUNGHAN  
1 ALMADEN BOULEVARD, SUITE 500  
SAN JOSE, CA 95113  
TEL: 408.283.3000

**Traffic**  
KIMLEY-HORN  
10 SOUTH ALMADEN BOULEVARD, SUITE 1250  
SAN JOSE, CA 95113  
TEL: 669.800.4130

**Parking Engineering**  
WATRY DESIGN, INC.  
2099 GATEWAY PLACE, SUITE 550  
SAN JOSE, CA 95110  
TEL: 833.917.7275

**Logistics**  
ARUP  
260 MISSION STREET, SUITE 700  
SAN FRANCISCO, CA 94105  
TEL: 415.957.9445

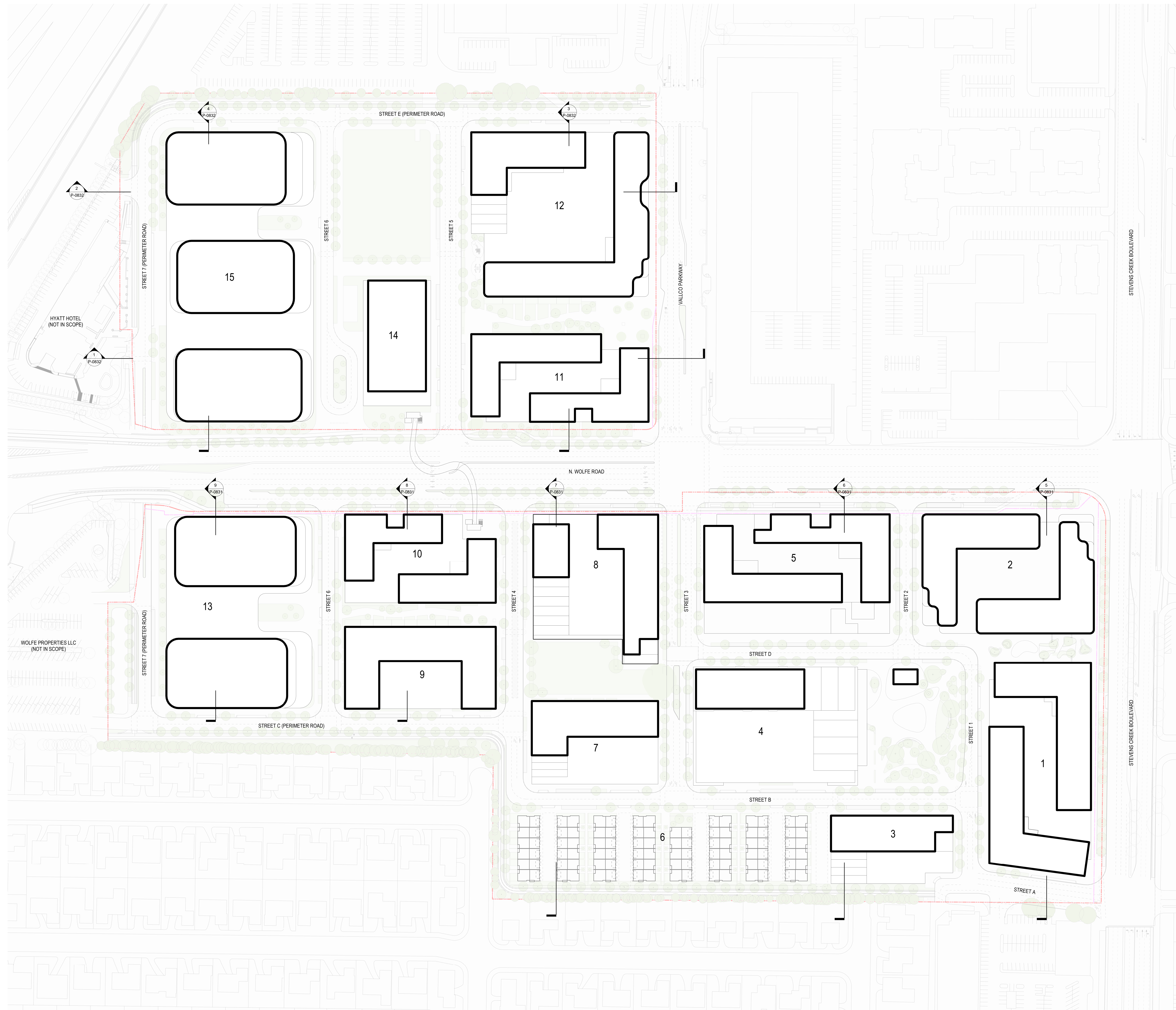

**SB 35 MODIFICATION APPLICATION**

Revision		
No.	Description	Date
REV-4	SB-35 MODIFICATION APPLICATION	12/04/2023
REV-3	SB-35 MODIFICATION APPLICATION	09/22/2022
REV-2	SB-35 APPLICATION - CONSENT SET	09/15/2019
REV-1	SB-35 APPLICATION - REVISION	08/06/2018
REV-0	SB-35 DEVELOPMENT APPLICATION	03/27/2018

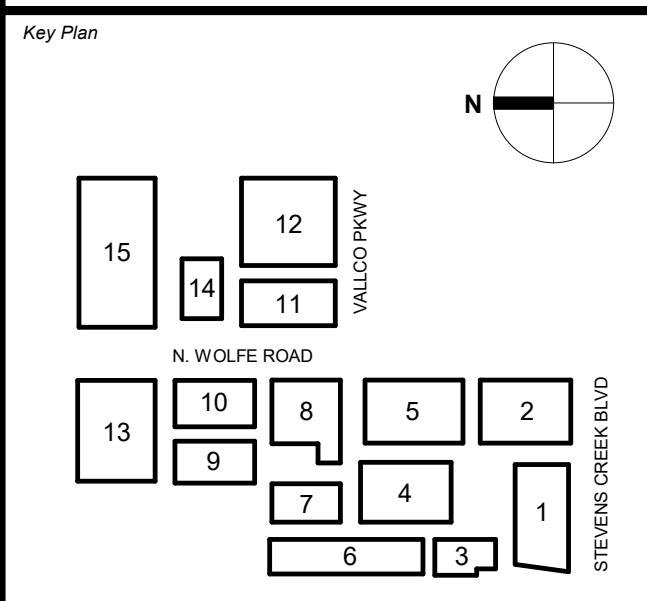

Scale & Signature

**NOT FOR CONSTRUCTION**

Issue Date: 03/27/2024 Project No: 3462  
Scale: 1/8" = 1'-0"

Drawing Title  
**BUILDING PLAN - ROOF PLAN**

**P-0800.24**

1 TYPICAL ROOF PLAN  
SCALE: 1/8" = 1'-0"