

Client
VALCO PROPERTY OWNER LLC
2005 EL CAMINO REAL, SUITE 410
PALO ALTO, CA 94306
TEL: 650.344.1500

Architecture
KOHN PEDERSEN FOX ASSOCIATES PC
11 WEST 42ND STREET
NEW YORK, NY 10036
TEL: 212.877.6500

Architecture
KOHN PEDERSEN FOX ASSOCIATES PC
2 EMBARCADERO CENTER
SAN FRANCISCO, CA 94111
TEL: 415.944.5491

Landscape Architecture
OLIN
1617 JOHN F. KENNEDY BOULEVARD, SUITE 1900
PHILADELPHIA, PA 19103
TEL: 215.440.0030

Civil
SANDIS
170 S. WINCHESTER BOULEVARD, SUITE 200
CAMPBELL, CA 95113
TEL: 408.636.0900

Lighting Design
ONE LIX STUDIO
158 WEST 29TH STREET, 10TH FLOOR
NEW YORK, NY 10001
TEL: 212.201.5790

Structure
DCI ENGINEERS
135 MAIN STREET, SUITE 1800
SAN FRANCISCO, CA 94105
TEL: 415.781.1505

MEP
MEYERS+ ENGINEERS
98 BATTERY STREET, SUITE 500
SAN FRANCISCO, CA 94111
TEL: 415.432.8101

Geotechnical
JUNGHAN
1 ALMADEN BOULEVARD, SUITE 500
SAN JOSE, CA 95113
TEL: 408.263.3000

Traffic
KIMLEY-HORN
10 SOUTH ALMADEN BOULEVARD, SUITE 1250
SAN JOSE, CA 95113
TEL: 669.800.4130

Parking Engineering
WATRY DESIGN, INC.
2099 GATEWAY PLACE, SUITE 550
SAN JOSE, CA 95110
TEL: 833.917.7275

Logistics
ARUP
801 MISSION STREET, SUITE 700
SAN FRANCISCO, CA 94105
TEL: 415.957.9445

LEGEND

- RESIDENTIAL
- RESIDENTIAL PARKING
- RETAIL
- RETAIL PARKING
- OFFICE
- OFFICE PARKING
- CORE / CORRIDOR / BOH

NOTES

1. INTERIOR DEMISING PARTITIONS FOR OFFICE, RETAIL, AND RESIDENTIAL ARE ILLUSTRATIVE AND SUBJECT TO CHANGE WITH TENANT FIT-OUT.
2. PARKING LAYOUT IS PRELIMINARY TO BE FINALIZED WITH BUILDING PERMITS.

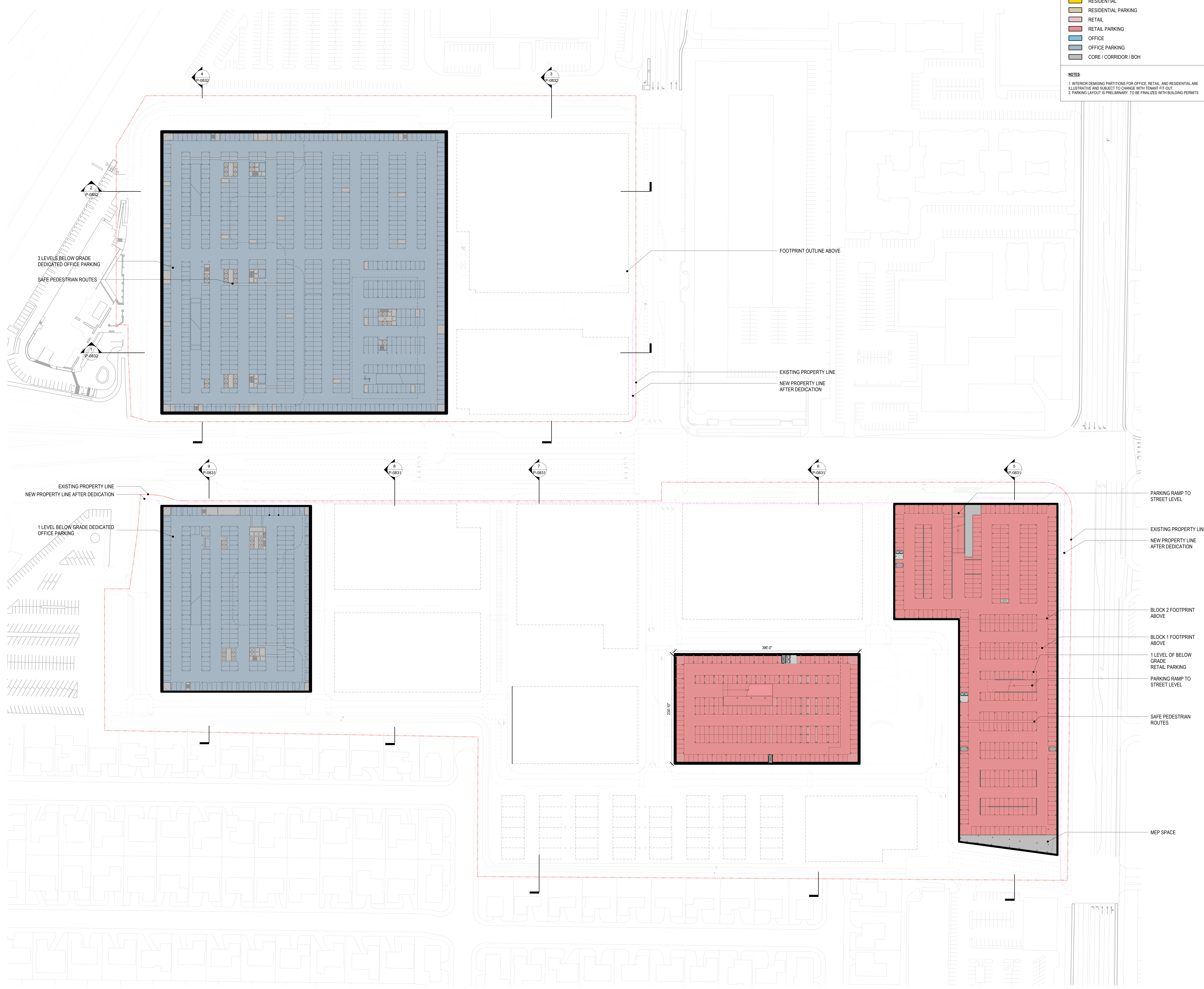

SB 35 MODIFICATION APPLICATION

Revision

Rev. No.	Description	Date
REV. 5	SB-35 MODIFICATION APPLICATION	12/04/2023
REV. 4	SB-35 MODIFICATION APPLICATION	05/24/2022
REV. 3	SB-35 MODIFICATION APPLICATION	03/23/2022
REV. 2	SB-35 APPLICATION - CONSENT SET	09/15/2019
REV. 1	SB-35 APPLICATION - REVISION	08/06/2018
REV. 0	SB-35 DEVELOPMENT APPLICATION	03/27/2018

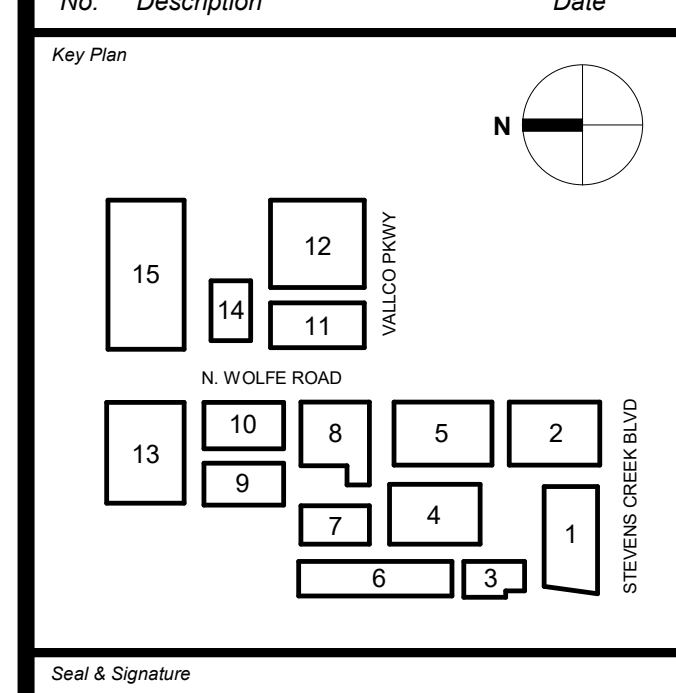

Seal & Signature

NOT FOR CONSTRUCTION

Issue Date: 03/27/2024 Project No: 3462
Scale: 1/8" = 1'-0"

Drawing Title
BUILDING PLAN - TYPICAL BASEMENT LEVEL

P-0800.0B1

1 LEVEL B1
SCALE: 1/8" = 1'-0"