

**Client**  
VALCO PROPERTY OWNER LLC  
2000 EL CAMINO REAL, SUITE 410  
PALO ALTO, CA 94306  
TEL: 650.344.1500

**Architecture**  
KOHN PEDERSEN FOX ASSOCIATES PC  
11 WEST 42ND STREET  
NEW YORK, NY 10036  
TEL: 212.877.6500

**Architecture**  
KOHN PEDERSEN FOX ASSOCIATES PC  
2 EMBARCADERO CENTER  
SAN FRANCISCO, CA 94111  
TEL: 415.944.5491

**Landscape Architecture**  
OLIN  
1817 JOHN F. KENNEDY BOULEVARD, SUITE 1900  
PHILADELPHIA, PA 19103  
TEL: 215.440.0030

**Civil**  
SANDS  
1700 S WINCHESTER BOULEVARD, SUITE 200  
CAMPBELL, CA 95113  
TEL: 408.636.0000

**Lighting Design**  
ONE LUX STUDIO  
158 WEST 29TH STREET, 10TH FLOOR  
NEW YORK, NY 10001  
TEL: 212.201.5790

**Structure**  
DCI ENGINEERS  
135 MAIN STREET, SUITE 1800  
SAN FRANCISCO, CA 94105  
TEL: 415.781.1505

**MEP**  
MEYERS+ ENGINEERS  
98 BATTERY STREET, SUITE 500  
SAN FRANCISCO, CA 94111  
TEL: 415.432.8101

**Geotechnical**  
JANGHAM  
1 ALMADEN BOULEVARD, SUITE 500  
SAN JOSE, CA 95131  
TEL: 408.283.3000

**Traffic**  
KIMLEY-HORN  
10 SOUTH ALMADEN BOULEVARD, SUITE 1250  
SAN JOSE, CA 95113  
TEL: 408.900.4300

**Parking Engineering**  
WATRY DESIGN, INC.  
2000 GATEWAY PLACE, SUITE 550  
SAN JOSE, CA 95110  
TEL: 833.917.7275

**Logistics**  
ARUP  
600 MISSION STREET, SUITE 700  
SAN FRANCISCO, CA 94105  
TEL: 415.957.2445

## SB 35 MODIFICATION APPLICATION

### Revision

No.	Description	Date
REV-4	SB-35 MODIFICATION APPLICATION	11/04/2023
REV-3	SB-35 MODIFICATION APPLICATION	03/23/2023
REV-2	SB-35 APPLICATION CONFORM SET	09/15/2018
REV-1	SB-35 APPLICATION - REVISION	08/06/2018
REV-0	SB-35 DEVELOPMENT APPLICATION	03/27/2018

No.	Description	Date
15		
14		
13		
12		
11		
10		
9		
8		
7		
6		
5		
4		
3		
2		
1		

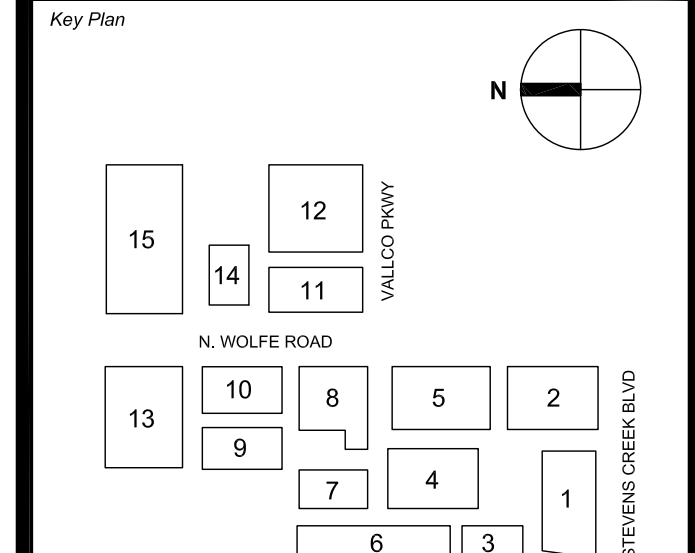

Scale & Signature

**NOT FOR CONSTRUCTION**

Issue Date: 2023.12.04 Project No.:  
Scale: 1/8" = 1'-0" Project Number:

Drawing Title:  
**EXTERIOR PHOTOMETRIC PLAN - STREET LEVEL**

**P-0704**

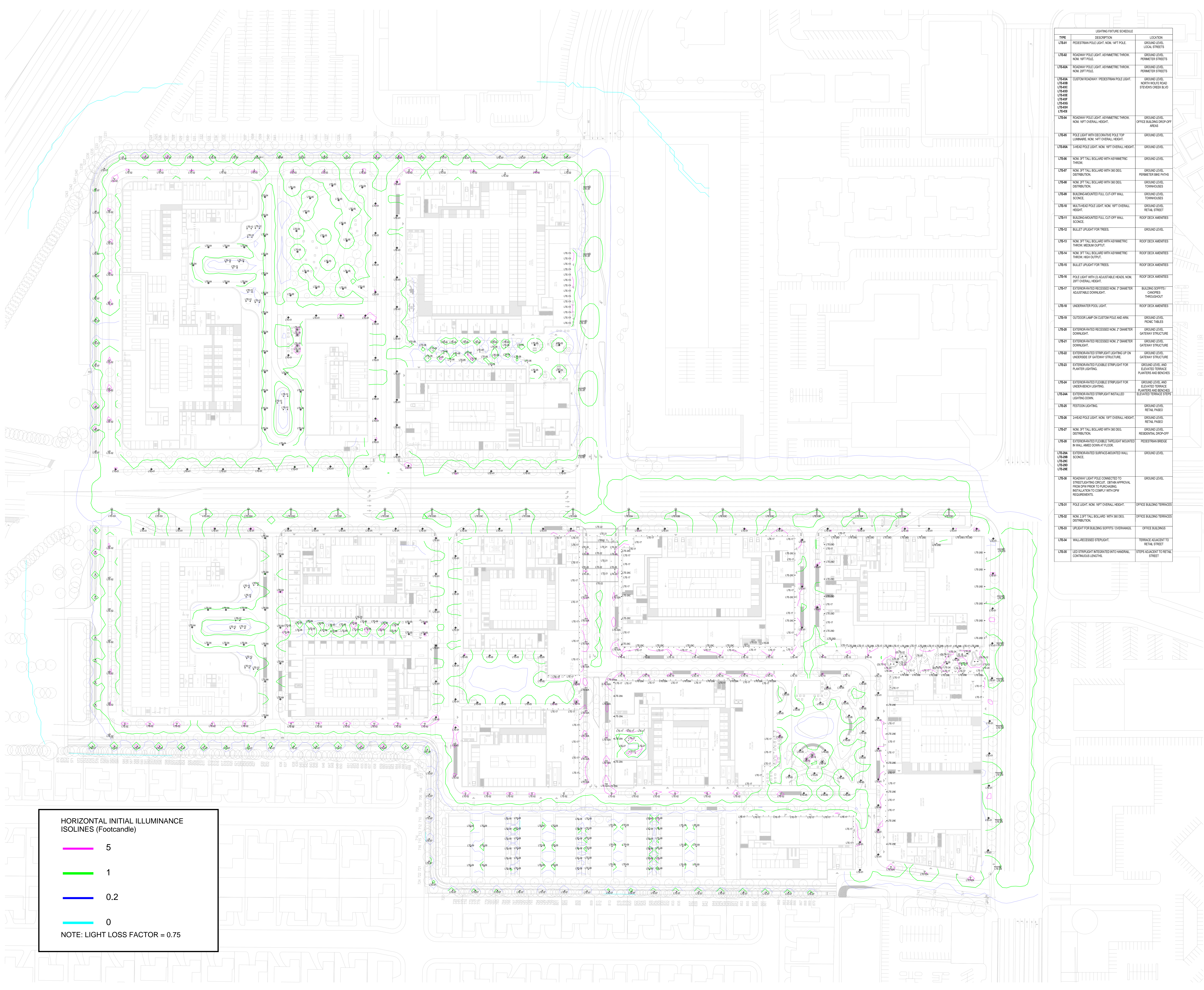

**HORIZONTAL INITIAL ILLUMINANCE ISOLINES (Footcandle)**

- 5
- 1
- 0.2
- 0

NOTE: LIGHT LOSS FACTOR = 0.75