

**Client**  
VALCO PROPERTY OWNER LLC  
200 EL CAMINO REAL, SUITE 410  
PALO ALTO, CA 94306  
TEL: 650.344.1500

**Architecture**  
KOHN PEDERSEN FOX ASSOCIATES PC  
11 WEST 42ND STREET  
NEW YORK, NY 10036  
TEL: 212.877.6900

**Architecture**  
KOHN PEDERSEN FOX ASSOCIATES PC  
2 EMBARCADERO CENTER  
SAN FRANCISCO, CA 94111  
TEL: 415.944.5491

**Landscape Architecture**  
OLIN  
1617 JOHN F. KENNEDY BOULEVARD, SUITE 1900  
PHILADELPHIA, PA 19103  
TEL: 215.440.0030

**Civil**  
SANDIS  
1702 S. WINCHESTER BOULEVARD, SUITE 200  
CAMPBELL, CA 95113  
TEL: 408.636.0900

**Lighting Design**  
ONE LUX STUDIO  
158 WEST 29TH STREET, 10TH FLOOR  
NEW YORK, NY 10001  
TEL: 212.251.5790

**Structure**  
DCI ENGINEERS  
135 MAIN STREET, SUITE 1800  
SAN FRANCISCO, CA 94105  
TEL: 415.781.1505

**MEP**  
MEYERS+ ENGINEERS  
98 BATTERY STREET, SUITE 500  
SAN FRANCISCO, CA 94111  
TEL: 415.432.8101

**Geotechnical**  
LANGHAM  
1 ALMADEN BOULEVARD, SUITE 500  
SAN JOSE, CA 95113  
TEL: 408.263.3000

**Traffic**  
KIMLEY-HORN  
10 SOUTH ALMADEN BOULEVARD, SUITE 1250  
SAN JOSE, CA 95113  
TEL: 669.800.4130

**Parking Engineering**  
WATRY DESIGN, INC.  
2089 GATEWAY PLACE, SUITE 550  
SAN JOSE, CA 95110  
TEL: 833.917.7275

**Logistics**  
ARUP  
650 MISSION STREET, SUITE 700  
SAN FRANCISCO, CA 94105  
TEL: 415.957.9445

### LEGEND

	PROPERTY LINE	
	PROPERTY LINE AFTER DEDICATION	
	STRUCTURE	
	EXISTING TREE TO BE REMOVED AND REPLACED BY I-205 HIGHWAY RAMP PROJECT	25
	EXISTING STANDARD TREE TO REMAIN	246
	EXISTING STANDARD TREE TO BE REMOVED	461
	EXISTING TREE TO BE TRANSPLANTED	10
	DEVELOPMENT TREE TO BE REMOVED	90
	EXISTING STREET TREE TO REMAIN	0
	EXISTING STREET TREE TO BE REMOVED	163
	EXISTING STREET TREE TO BE REMOVED IN 0.25% OVERALL CONDITION RATINGS	
	<b>TOTAL TREE</b>	<b>995</b>

FOR DETAILS OF EXISTING TREE CONDITIONS, SEE ARBORIST REPORT DATED DECEMBER 4, 2023, PREPARED BY WALTER LEVISON, CONSULTING ARBORIST (WVCA).

PROJECT ARBORIST RECOMMENDS REMOVAL OF TREES RATED WITH 0% TO 25% OVERALL CONDITION RATINGS.



### SB 35 MODIFICATION APPLICATION

#### Revision

Rev.	Description	Date
REV-5	SB-35 MODIFICATION APPLICATION	12/04/2023
REV-4	SB-35 MODIFICATION APPLICATION	03/23/2022
REV-3	SB-35 APPLICATION CONFORM SET	09/16/2018
REV-2	SB-35 APPLICATION - REVISIONS	08/06/2018
REV-1	SB-35 APPLICATION - REVISIONS	07/31/2018
REV-0	SB-35 DEVELOPMENT APPLICATION	03/27/2018

Key Plan

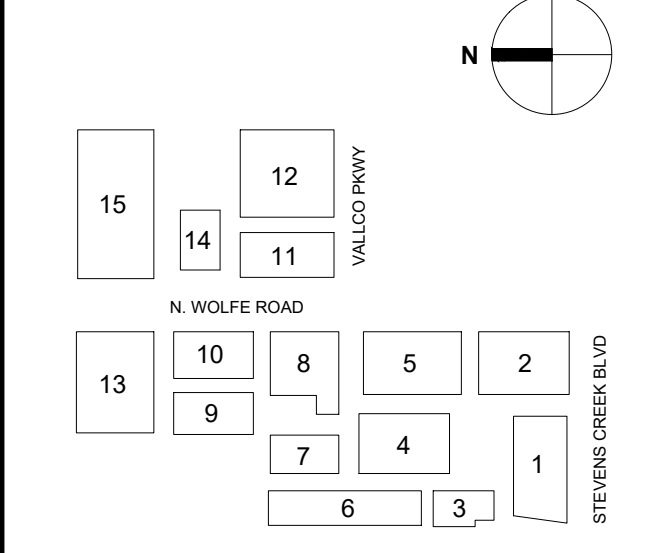

Scale & Signature

**NOT FOR CONSTRUCTION**

Issue Date: 12/04/2023 Project No: 3462

Drawing Title: **TREE DISPOSITION PLAN**

**P-0602B**