

LEGEND

- PUBLIC FIRE HYDRANT
- PRIVATE FIRE HYDRANT

FIRE NOTES

- THE CITY OF CUPERTINO AMENDS SANTA CLARA COUNTY FIRE REQUIREMENTS.
- ALL HYDRANT LOCATIONS SHOWN SHALL BE FINALIZED AND COORDINATED WITH THE APPROPRIATE FIRE DISTRICTS AND SHALL MEET THE SPACING AND FLOW REQUIREMENTS SHOWN BELOW.
- ALL FIRE APPARATUS SHALL COMPLY WITH APPLICABLE CODES, INCLUDING THE APPLICABLE CALIFORNIA BUILDING CODE, THE 2016 CALIFORNIA FIRE CODE, AND CODES AND STANDARDS FROM THE NATIONAL FIRE PROTECTION ASSOCIATION.

Client
 VALCO PROPERTY OWNER LLC
 2001 D CAMINO REAL, SUITE 410
 PALO ALTO, CA 94306
 TEL: 650.344.1500

Architecture
 KOHN PEDERSEN FOX ASSOCIATES PC
 11 WEST 42ND STREET
 NEW YORK, NY 10036
 TEL: 212.877.6000

Architecture
 KOHN PEDERSEN FOX ASSOCIATES PC
 2 EMBARCADERO CENTER
 SAN FRANCISCO, CA 94111
 TEL: 415.944.5491

Landscape Architecture
 OLIN
 1617 JOHN F. KENNEDY BOULEVARD, SUITE 1900
 PHILADELPHIA, PA 19103
 TEL: 215.440.0030

Civil
 SANDS
 1700 S. WINCHESTER BOULEVARD, SUITE 200
 CAMPBELL, CA 95113
 TEL: 408.636.0900

Lighting Design
 ONE LUX STUDIO
 158 WEST 20TH STREET, 10TH FLOOR
 NEW YORK, NY 10011
 TEL: 212.201.5790

Structure
 DCI ENGINEERS
 135 MAIN STREET, SUITE 1800
 SAN FRANCISCO, CA 94105
 TEL: 415.781.1505

MEP
 MEYERS+ ENGINEERS
 98 BATTERY STREET, SUITE 500
 SAN FRANCISCO, CA 94111
 TEL: 415.432.8101

Geotechnical
 LANGRISH
 1 ALMADEN BOULEVARD, SUITE 500
 SAN JOSE, CA 95131
 TEL: 408.283.3000

Traffic
 KIMLEY-HORN
 10 SOUTH ALMADEN BOULEVARD, SUITE 1250
 SAN JOSE, CA 95113
 TEL: 869.800.4130

Parking Engineering
 WATRY DESIGN, INC.
 2089 GATEWAY PLACE, SUITE 500
 SAN JOSE, CA 95110
 TEL: 833.917.7275

Logistics
 ARUP
 950 MISSION STREET, SUITE 700
 SAN FRANCISCO, CA 94105
 TEL: 415.957.9445

FIRE FLOW REQUIREMENTS										
BUILDING	CONSTRUCTION TYPE	GROSS BUILDING FLOOR AREA (SF)	FULLY SPRINKLERED	REFERENCE FIRE FLOW (GPM)	ALLOWED FIRE FLOW REDUCTION	REQUIRED FIRE FLOW (GPM)	REQUIRED FIRE FLOW DURATION (HRS)	REQUIRED NUMBER OF HYDRANTS	AVERAGE HYDRANT SPACING (FT)	MAX DISTANCE FROM STREET TO HYDRANT (FT)
1A & 1B	IIIA	373,404	YES	6000	50%	3000	3	3	400	225
2A & 2B	IIIA	457,102	YES	6000	50%	3000	3	3	400	225
3	IIIA	163,232	YES	5750	50%	2875	2	3	400	225
4	IA*	153,414	YES	4750	50%	2375	2	3	450	225
5A & 5B	IIIA	423,997	YES	6000	50%	3000	3	3	400	225
6	V	138,202	YES	6750	50%	3375	3	4	350	210
7	IIIA	201,753	YES	6000	50%	3000	2	3	400	225
9	IIIA	323,559	YES	6000	50%	3000	3	3	400	225
10A & 10B	IIIA	309,660	YES	6000	50%	3000	3	3	400	225
11A & 11B	IIIA	343,565	YES	6000	50%	3000	3	3	400	225
13A & 13B	IA*	207,701	YES	5000	50%	2500	2	3	450	225
14	IA*	98,476	YES	3500	50%	1750	2	1	500	250
15	IA*	337,765	YES	6000	50%	3000	3	3	400	225

MIXED CONSTRUCTION FIRE FLOW REQUIREMENTS									
BUILDING	GROSS BUILDING FLOOR AREA (SF)	FULLY SPRINKLERED	REFERENCE FIRE FLOW (GPM)	ALLOWED FIRE FLOW REDUCTION	REQUIRED FIRE FLOW (GPM)	REQUIRED FIRE FLOW DURATION (HRS)	REQUIRED NUMBER OF HYDRANTS	AVERAGE HYDRANT SPACING (FT)	MAX DISTANCE FROM STREET TO HYDRANT (FT)
8A & 8B	306,479	YES	6000	50%	3000				
TYPE IIIA	157,361	YES	6000	25%	4500				
TYPE IA	463,840	YES	6000		3510	3	4	450	225
TOTAL									
12A & 12B	513,944	YES	6000	50%	3000				
TYPE IIIA	284,256	YES	6000	25%	4500				
TYPE IA	798,200	YES	6000		3530	3	4	450	225
TOTAL									

*CALCULATION AREAS OF BUILDINGS CONSTRUCTED OF TYPE IA CONSTRUCTION SHALL BE THE AREA OF THE THREE LARGEST SUCCESSIVE FLOORS PER CFC SECTION B104.3

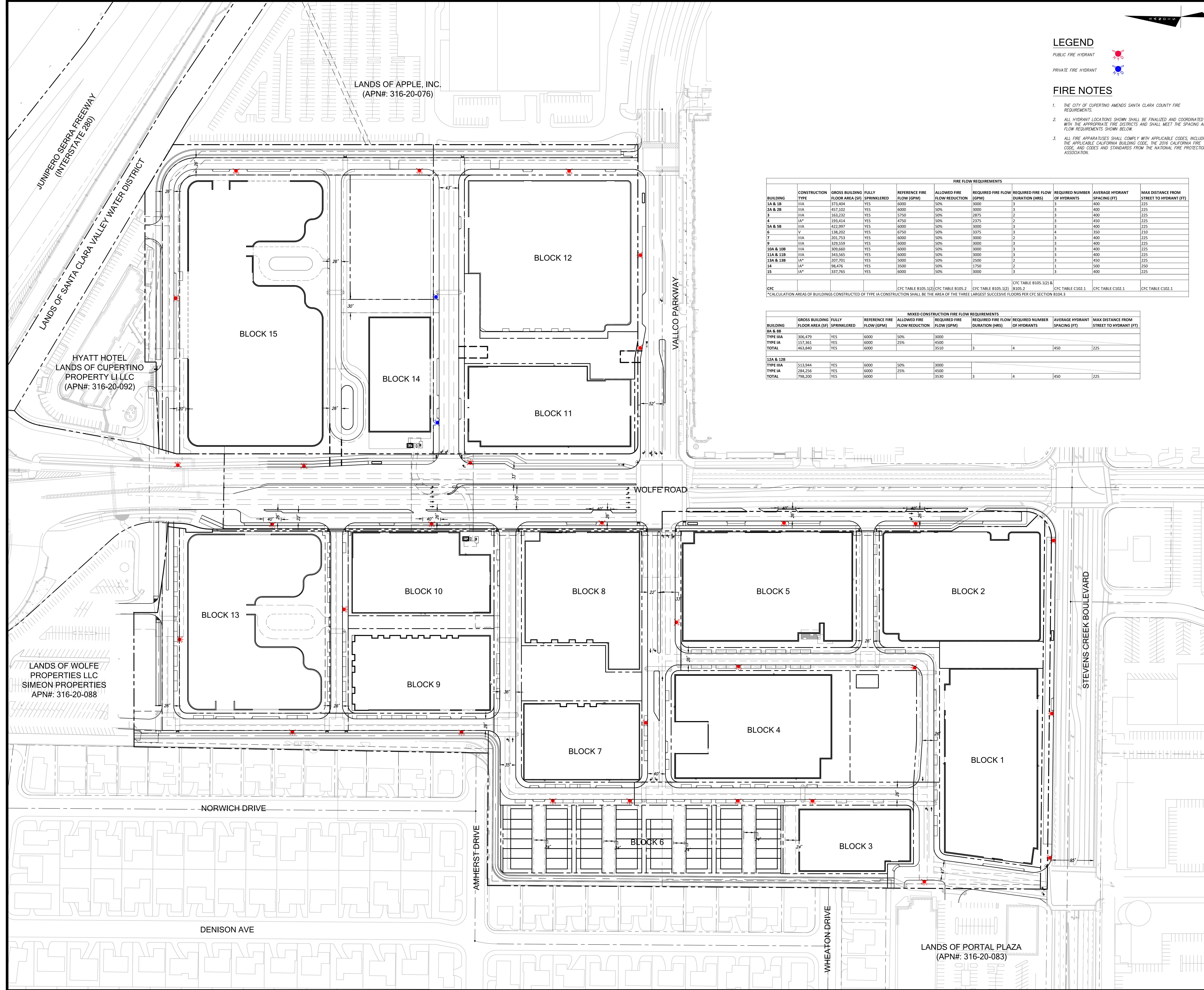

SB 35 MODIFICATION APPLICATION

Revision

Rev.	Description	Date
REV-5	SB-35 MODIFICATION APPLICATION	12/04/2023
REV-4	SB-35 MODIFICATION APPLICATION	05/27/2022
REV-3	SB-35 MODIFICATION APPLICATION	03/23/2022
REV-2	SB-35 APPLICATION - CONFORM SET	09/15/2018
REV-1	SB-35 APPLICATION - REVISION	08/06/2018
REV-0	SB-35 DEVELOPMENT - APPLICATION	03/27/2018

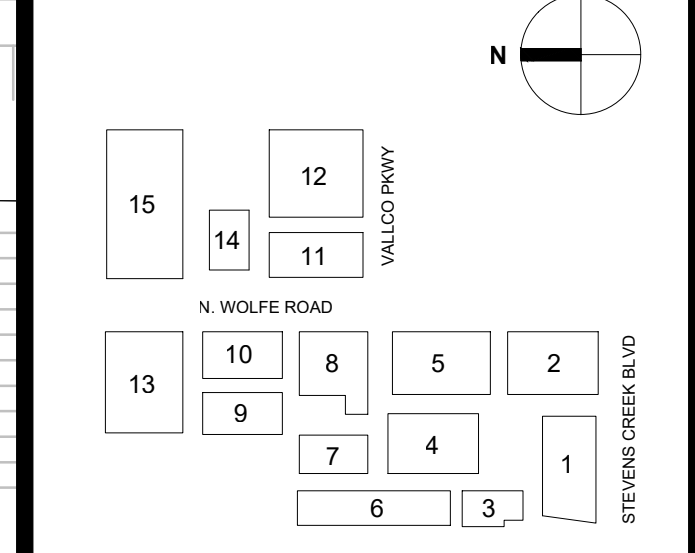

Scale & Signature

NOT FOR CONSTRUCTION

Issue Date: 12/04/2023 Project No: 22337

Drawing Title: **FIRE HYDRANT LAYOUT PLAN - STREET LEVEL**