



### LEGEND

PROPERTY LINE	---
STREET LEVEL PLAN - BUILDING	—
STREET LEVEL PLAN - CURB	—
UNDERGROUND PARKING	—
DRAINAGE BOUNDARY LINE	---
IMPERVIOUS AREA	■
LANDSCAPE AREA	■
PROPOSED POOLS BEING DIRECTED TO SANITARY SEWER	■
EXISTING TREE CREDIT	○
PROPOSED TREE CREDIT	○
PROPOSED SILVA CELLS	■
DRAINAGE AREA NUMBER	⚡
TREATMENT CONTROL MEASURE NUMBER	⚡
FLOW DIRECTION	→

### HYDROMODIFICATION NOTE:

THIS SITE ADDS/REPLACES MORE THAN 1 ACRE OF IMPERVIOUS AREA, BUT IS EXEMPT FROM HYDROMODIFICATION REQUIREMENTS BECAUSE THE ENTIRE SITE IS LOCATED IN A CATCHMENT OR SUBWATERSHED THAT IS DETERMINED TO BE GREATER THAN 65% IMPERVIOUS PER THE 2010 HMP APPLICABILITY MAP, SHOWN ON SHEET P-0404.

<b>Client</b>	VALLCO PROPERTY OWNER LLC 200 EL CAMINO REAL, SUITE 410 PALO ALTO, CA 94306 TEL: 650.344.1500
<b>Architecture</b>	KOHN PEDERSEN FOX ASSOCIATES PC 11 WEST 42ND STREET NEW YORK, NY 10036 TEL: 212.877.6500
<b>Architecture</b>	KOHN PEDERSEN FOX ASSOCIATES PC 2 EMBARCADERO CENTER SAN FRANCISCO, CA 94111 TEL: 415.944.5491
<b>Landscape Architecture</b>	OLIN 1817 JOHN F. KENNEDY BOULEVARD, SUITE 1900 PHILADELPHIA, PA 19103 TEL: 215.440.0030
<b>Civil</b>	SANDIS 1700 S. WINCHESTER BOULEVARD, SUITE 200 CAMPBELL, CA 95113 TEL: 408.638.0900
<b>Lighting Design</b>	ONE LUX STUDIO 158 WEST 20TH STREET, 10TH FLOOR NEW YORK, NY 10001 TEL: 212.201.5790
<b>Structure</b>	DCI ENGINEERS 135 MAIN STREET, SUITE 1800 SAN FRANCISCO, CA 94105 TEL: 415.781.1505
<b>MEP</b>	MEYERS+ ENGINEERS 98 BATTERY STREET, SUITE 500 SAN FRANCISCO, CA 94111 TEL: 415.432.8101
<b>Geotechnical</b>	LANGRAN 1 ALMADEN BOULEVARD, SUITE 500 SAN JOSE, CA 95113 TEL: 408.283.3000
<b>Traffic</b>	KIMLEY-HORN 10 SOUTH ALMADEN BOULEVARD, SUITE 1250 SAN JOSE, CA 95113 TEL: 669.800.4130
<b>Parking Engineering</b>	WATRY DESIGN, INC. 2080 GATEWAY PLACE, SUITE 550 SAN JOSE, CA 95110 TEL: 833.917.7275
<b>Logistics</b>	ARUP 850 MISSION STREET, SUITE 700 SAN FRANCISCO, CA 94105 TEL: 415.957.9445

### SB 35 MODIFICATION APPLICATION

Revision		
REV-4	SB-35 MODIFICATION APPLICATION	12/04/2023
REV-3	SB-35 MODIFICATION APPLICATION	03/20/2023
REV-2	SB-35 APPLICATION - CONFORM SET	09/15/2018
REV-1	SB-35 APPLICATION - REVISION	08/06/2018
REV-0	SB-35 DEVELOPMENT APPLICATION	03/07/2018
No.	Description	Date

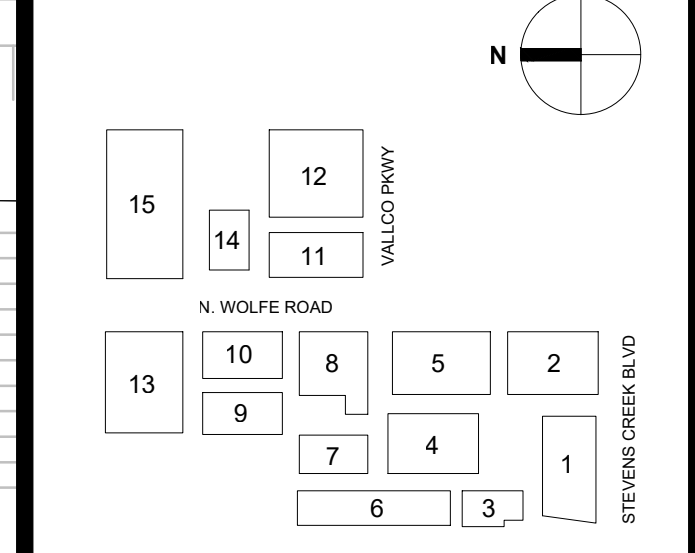

Scale & Signature

**NOT FOR CONSTRUCTION**

Issue Date: 12/04/2023 Project No: 223037  
 Scale: Drawing Title:

**STORM WATER MANAGEMENT PLAN - STREET LEVEL**

## P-0403

