



LEGEND

- PROPERTY LINE
- CENTERLINE
- PROPOSED RIGHT-OF-WAY
- PROPOSED PARCEL LINE

PLAN NOTES:

THE INTENT OF THE TENTATIVE MAP WILL BE TO CREATE 93 PARCELS. PARCELS ARE ESTABLISHED FOR CONDOMINIUM PURPOSES THAT SHALL BE SUBMITTED IN ACCORDANCE WITH SB 35 [AND PURSUANT TO GOVERNMENT CODE 66426 AND GOVERNMENT CODE 66427(A)] FOR DEVELOPMENT, FINANCING, CONSTRUCTION, LEASING AND SALES PURPOSES, TO PERMIT CONDOMINIUM UNITS WITHIN THE RISE SB 35 PROJECT.

TENTATIVE MAP NOTE:

REFER TO TENTATIVE MAP PACKAGE FOR FINAL PARCELS, EASEMENTS, AND BOUNDARIES.

- Client**
VALCO PROPERTY OWNER LLC
200 CL CAMINO REAL, SUITE 410
PALO ALTO, CA 94306
TEL: 650.344.1500
- Architecture**
KOHN PEDERSEN FOX ASSOCIATES PC
11 WEST 42ND STREET
NEW YORK, NY 10036
TEL: 212.877.6000
- Architecture**
KOHN PEDERSEN FOX ASSOCIATES PC
2 EMBARCADERO CENTER
SAN FRANCISCO, CA 94111
TEL: 415.944.5491
- Landscape Architecture**
OLIN
1817 JOHN F. KENNEDY BOULEVARD, SUITE 1900
PHILADELPHIA, PA 19103
TEL: 215.440.0030
- Civil**
SANDS
1700 S WINCHESTER BOULEVARD, SUITE 200
CAMPBELL, CA 95113
TEL: 408.638.0900
- Lighting Design**
ONE LUX STUDIO
158 WEST 29TH STREET, 10TH FLOOR
NEW YORK, NY 10001
TEL: 212.201.5790
- Structure**
DCI ENGINEERS
135 MAIN STREET, SUITE 1800
SAN FRANCISCO, CA 94105
TEL: 415.781.1505
- MEP**
MEYERS+ ENGINEERS
98 BATTERY STREET, SUITE 500
SAN FRANCISCO, CA 94111
TEL: 415.432.8101
- Geotechnical**
JANGJAN
1 ALMADEN BOULEVARD, SUITE 500
SAN JOSE, CA 95113
TEL: 408.293.3900
- Traffic**
KIMLEY-HORN
10 SOUTH ALMADEN BOULEVARD, SUITE 1250
SAN JOSE, CA 95113
TEL: 669.800.4130
- Parking Engineering**
WATRY DESIGN, INC.
2088 GATEWAY PLACE, SUITE 500
SAN JOSE, CA 95110
TEL: 833.917.7275
- Logistics**
ARUP
650 MISSION STREET, SUITE 700
SAN FRANCISCO, CA 94105
TEL: 415.957.9445

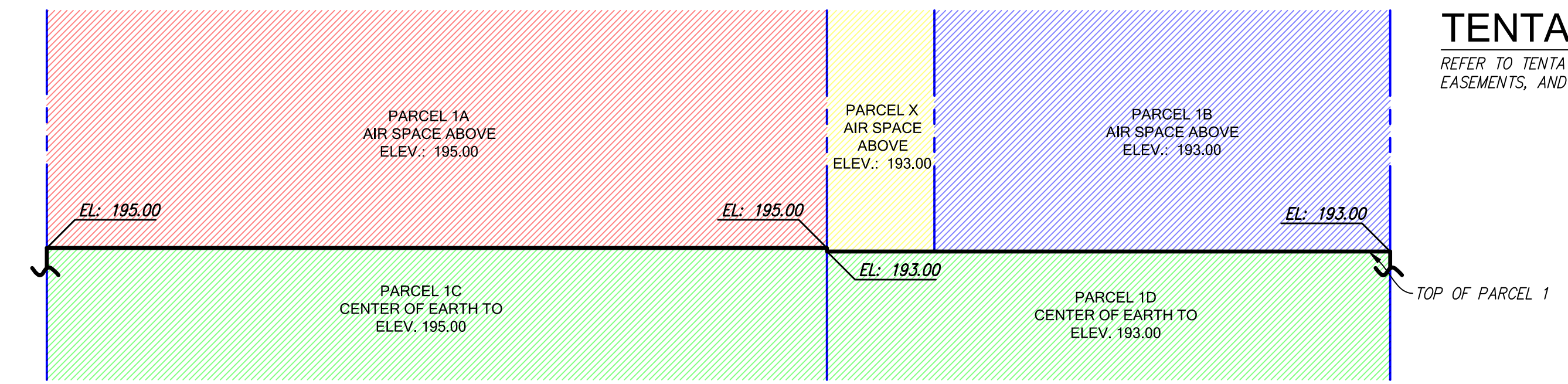

SECTION A - PARCELS 1A, 1B, 1C, 1D, X
1"=64'

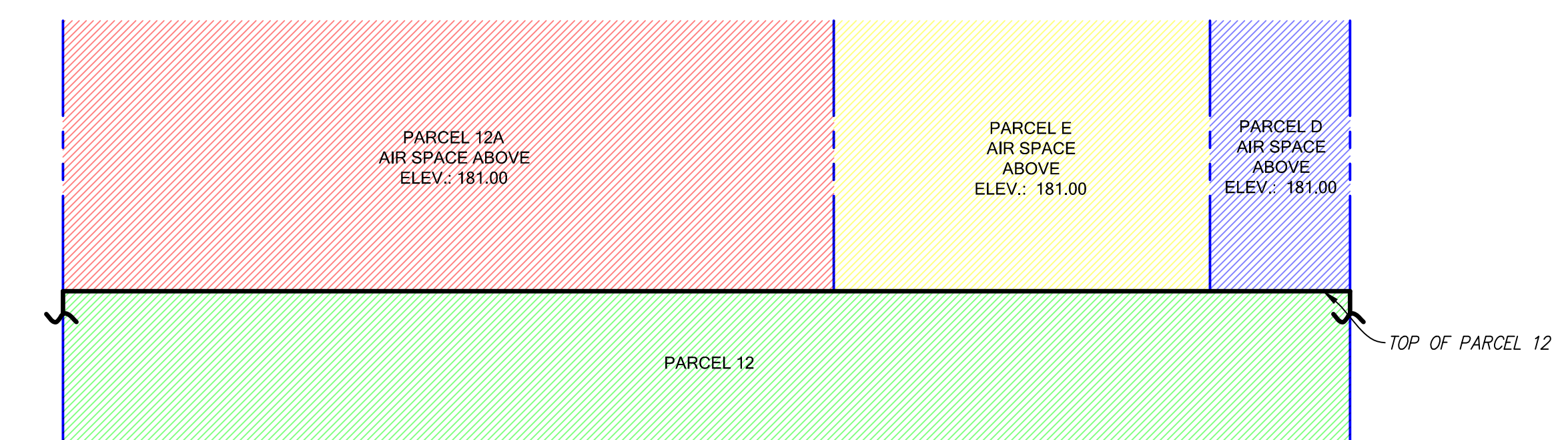

SECTION B - PARCELS 12, 12A, E, D
1"=64'

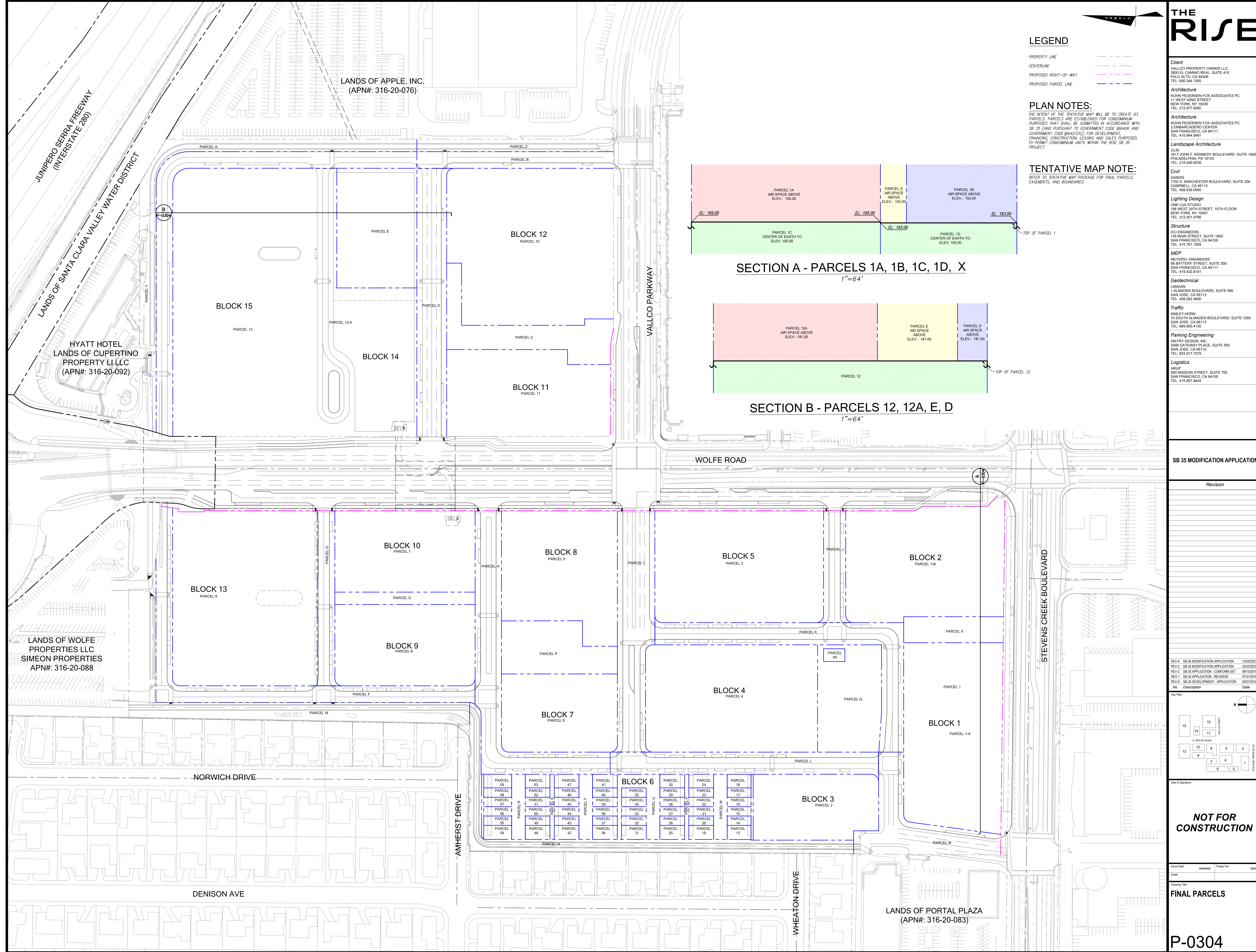

SB 35 MODIFICATION APPLICATION

Revision

Rev.	Description	Date
REV-4	SB 35 MODIFICATION APPLICATION	12/04/2023
REV-3	SB 35 MODIFICATION APPLICATION	03/20/2023
REV-2	SB 35 APPLICATION - CONFORM SET	09/15/2018
REV-1	SB 35 APPLICATION - REVISION	07/31/2018
REV-0	SB 35 DEVELOPMENT APPLICATION	03/27/2018

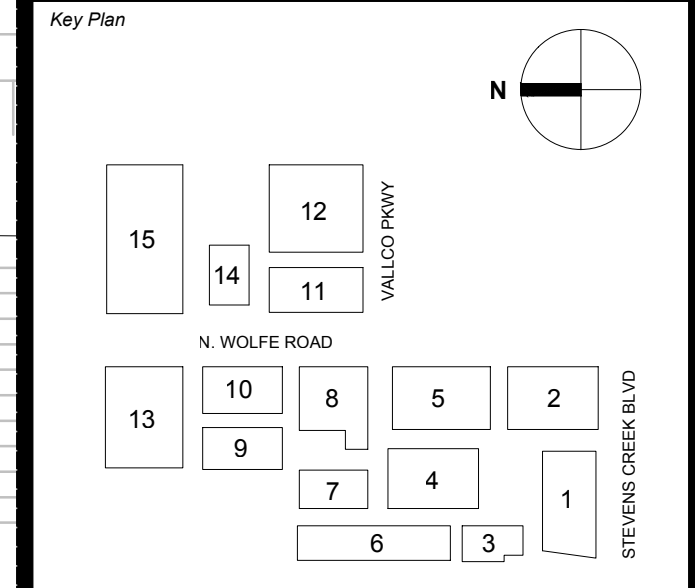

Scale & Signature

NOT FOR CONSTRUCTION

Issue Date: 10/04/2023 Project No: 22337

Drawing Title: **FINAL PARCELS**

P-0304